

VICINITY MAP

FROM U.S.G.S. MAMARONECK QUADRANGLE MAP

SCALE: 1:24000

PURPOSE: PRIVATE RECREATIONAL BOAT DOCKING
DATUM: NORTH AMERICAN VERTICAL DATUM OF 1988
ADJ. OWNERS: MARGARET HINCHCLIFFE; LOUANN LAYTON & ROBERT BEECROFT
APPLICATION PREPARED BY: JOHN HILTS P.O. BOX 47, ROWAYTON, CT 06853

PROPOSED LANDING, RAMP AND FLOATING DOCK IN MAMARONECK HARBOR AT
561 LAWN TERRACE, VILLAGE OF MAMARONECK, WESTCHESTER CTY., NY
APPLICATION BY: GIANNA KREY IRREVOCABLE TRUST
DATE: 2/02/22 SHEET 1 OF 4 REVISION NUMBER: DATE:

EXISTING GENERAL PLAN VIEW

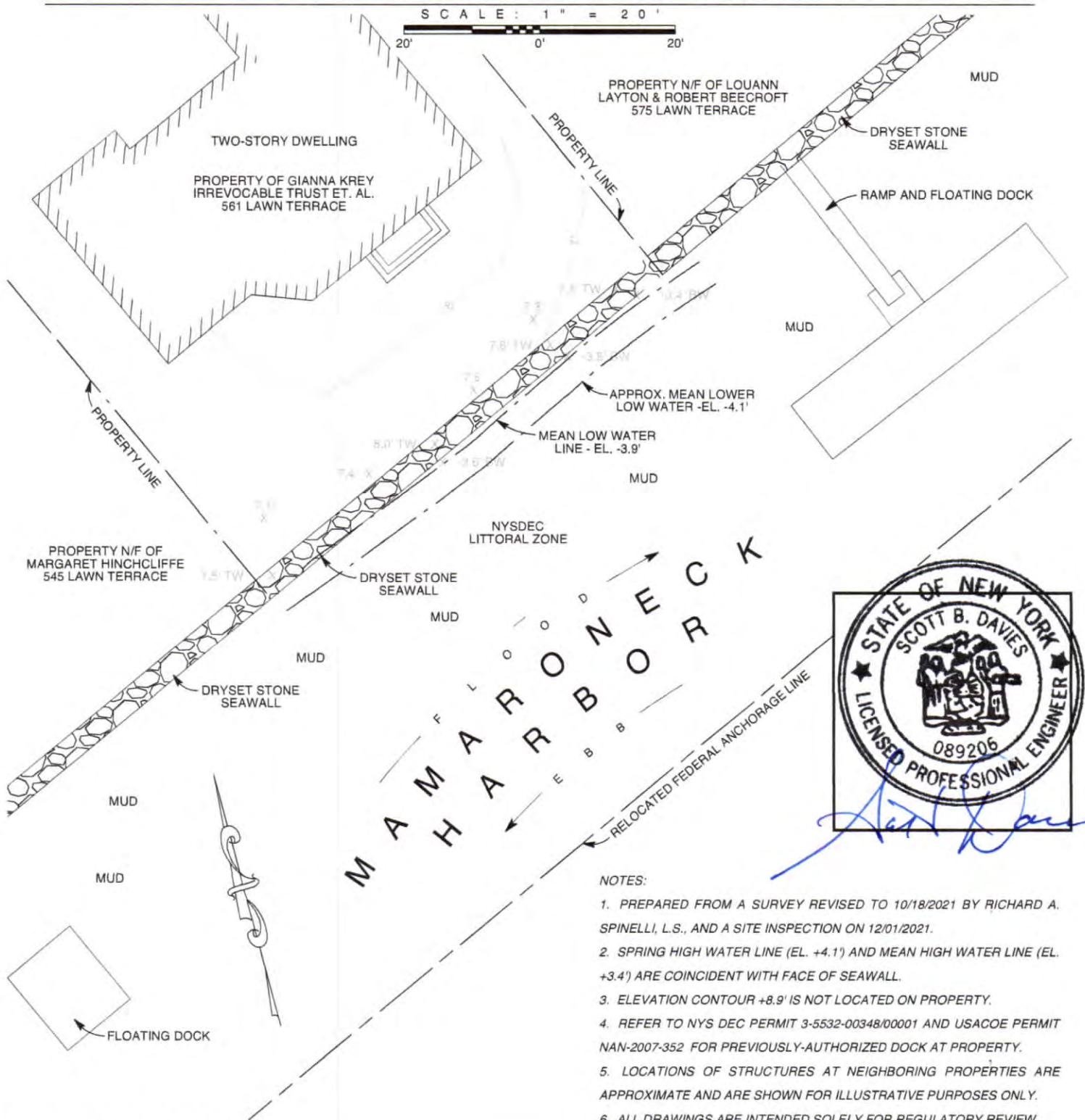

©2022 JOHN HILTS. ALL RIGHTS RESERVED.

PURPOSE: PRIVATE RECREATIONAL BOAT DOCKING
DATUM: NORTH AMERICAN VERTICAL DATUM OF 1988
ADJ. OWNERS: MARGARET HINCHCLIFFE; LOUANN LAYTON & ROBERT BEECROFT
APPLICATION PREPARED BY: JOHN HILTS P.O. BOX 47, ROWAYTON, CT 06853

PROPOSED LANDING, RAMP AND FLOATING DOCK IN MAMARONECK HARBOR AT
561 LAWN TERRACE, VILLAGE OF MAMARONECK, WESTCHESTER CTY., NY
APPLICATION BY: GIANNA KREY IRREVOCABLE TRUST
DATE: 2/02/22 SHEET 2 OF 4 REVISION NUMBER: 1 DATE: 9/01/22

PURPOSE: PRIVATE RECREATIONAL BOAT DOCKING
DATUM: NORTH AMERICAN VERTICAL DATUM OF 1988
ADJ. OWNERS: MARGARET HINCHCLIFFE; LOUANN LAYTON & ROBERT BEECROFT
APPLICATION PREPARED BY: JOHN HILTS P.O. BOX 47, ROWAYTON, CT 06853

PROPOSED LANDING, RAMP AND FLOATING DOCK IN MAMARONECK HARBOR AT
561 LAWN TERRACE, VILLAGE OF MAMARONECK, WESTCHESTER CTY., NY
APPLICATION BY: GIANNA KREY IRREVOCABLE TRUST
DATE: 2/02/22 SHEET 3 OF 4 REVISION NUMBER: 2 DATE: 9/01/22

PROPOSED ELEVATION

SCALE: 1" = 10'

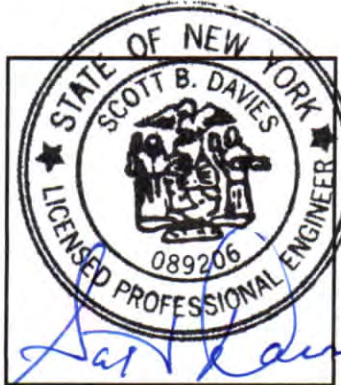
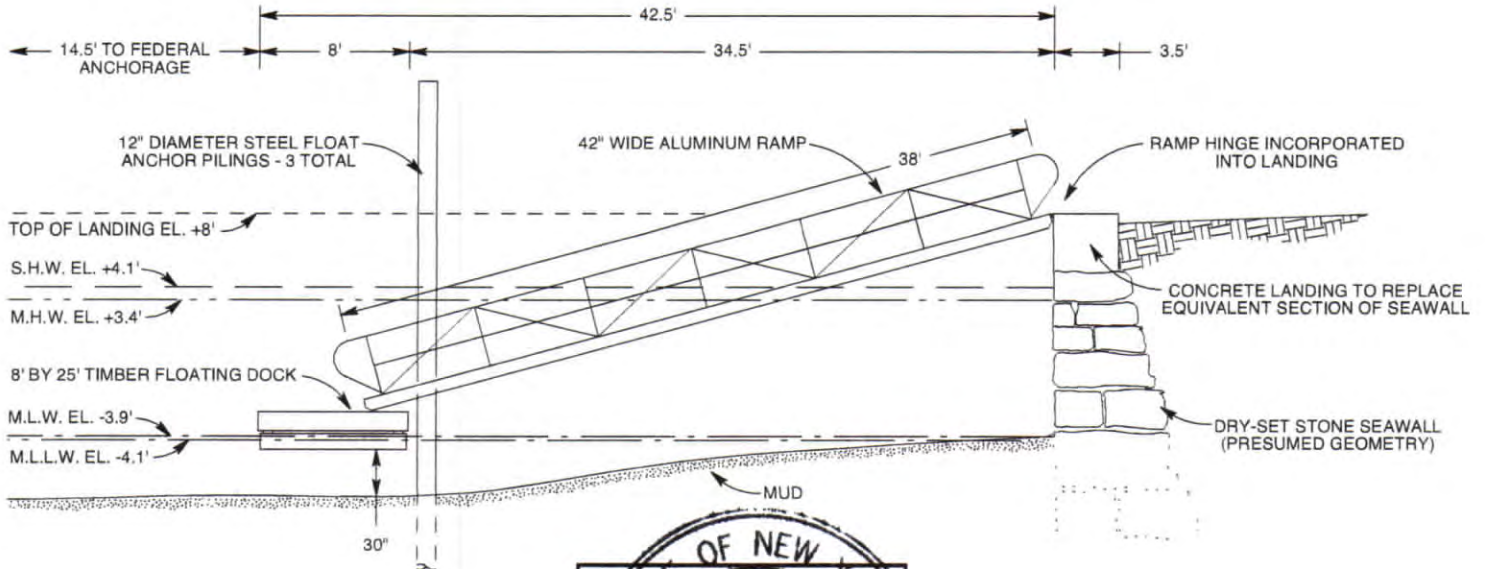

LANDING SECTION

SCALE: 1" = 5'

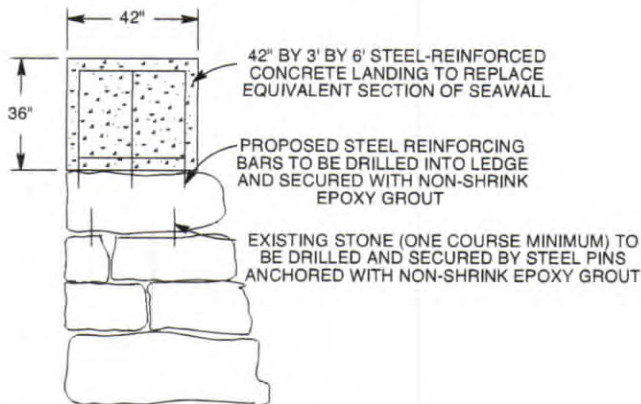

FLOATING DOCK SECTION

SCALE: 1" = 5'

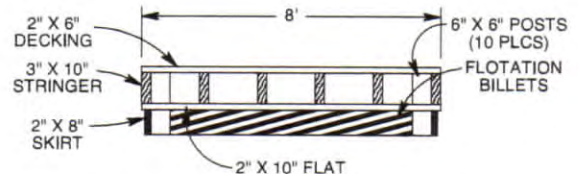

©2022 JOHN HILTS. ALL RIGHTS RESERVED.

NOTE: DRAWING IS FOR REGULATORY REVIEW ONLY.

PURPOSE: PRIVATE RECREATIONAL BOAT DOCKING
 DATUM: NORTH AMERICAN VERTICAL DATUM OF 1988
 ADJ. OWNERS: MARGARET HINCHCLIFFE; LOUANN LAYTON & ROBERT BEECROFT
 APPLICATION PREPARED BY: JOHN HILTS P.O. BOX 47, ROWAYTON, CT 06853

PROPOSED LANDING, RAMP AND FLOATING DOCK IN MAMARONECK HARBOR AT
 561 LAWN TERRACE, VILLAGE OF MAMARONECK, WESTCHESTER CT., NY
 APPLICATION BY: GIANNA KREY IRREVOCABLE TRUST
 DATE: 2/02/22 SHEET 4 OF 4 REVISION NUMBER: 2 DATE: 9/01/22