

MAMARONECK AVE

GENERAL NOTES:

1. ALL WORK SHALL CONFORM TO THE NEW YORK STATE UNIFORM FIRE PREVENTION AND BUILDING CODE, AND ALL LOCAL CODES.
2. OWNER TO SECURE AND PAY FOR ALL NECESSARY PERMITS AND LICENSES AND OBTAIN ALL REQUIRED APPROVALS INCLUDING CERTIFICATE OF OCCUPANCY/ COMPLIANCE.
3. CONTRACTOR TO PROVIDE AND MAINTAIN SITE SAFETY AS PER OSHA TO SAFEGUARD ALL PERSONS AND PROPERTY FOR DURATION OF WORK.
4. ALL ELECTRICAL/PLUMBING WORK SHALL BE FILED FOR SEPARATELY BY AN ELECTRICIAN/PLUMBER LICENSED BY THE MUNICIPALITY OF JURISDICTION.

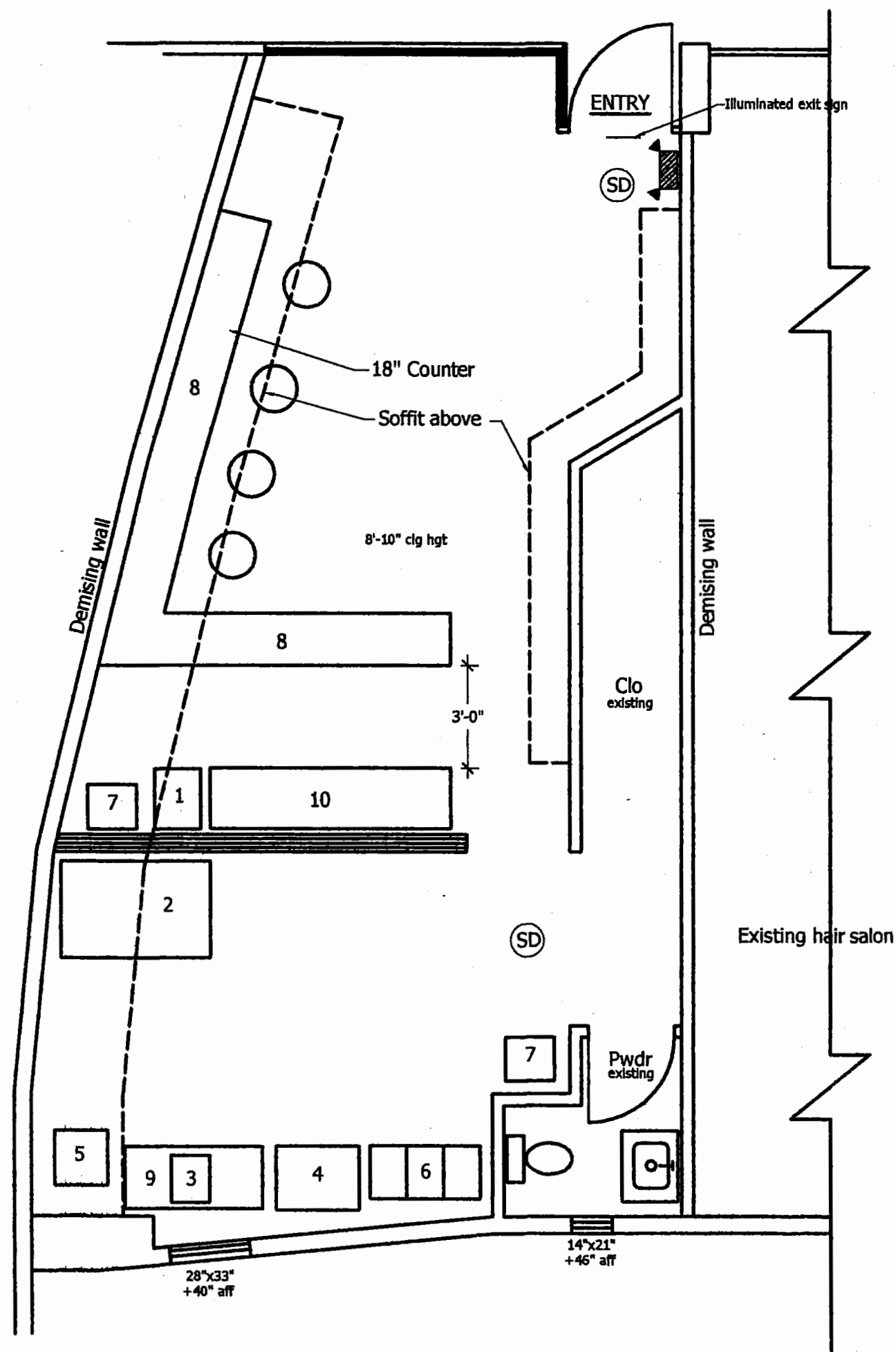

Floor Plan

Equipment List

1. Coffee machine 16"x21"
2. Fridge/Freezer 52"x33.75"
3. Induction stove 13.5"x16.5"
4. Ice machine 22.5"x29"
5. Hot water boiler 18.5"x19.5"
6. 3 bay sink-indirect waste 38.5"x18.75"
7. Hand sink 17"x15.5" w/soap & paper towel dispenser
8. Millwork counter 18"
9. Hood/fan 48"x22"
10. Stainless steel table 84"x18"

LEGEND:

- NEW PARTITION
- EXISTING PARTITION
- EXISTING TO BE REMOVED
- EMERGENCY EXIT LIGHTING HARDWIRED/BATTERY BACKUP
- SMOKE DETECTOR HARDWIRED/BATTERY BACKUP

WARNING

It is a violation of Section 7209.2 of the New York State Education Law for any person, unless acting under the direction of a licensed professional engineer, to alter in any way plans, specifications, plats or reports to which the seal of a professional engineer has been applied. If an item bearing the seal of a professional engineer is altered, the altering engineer shall affix to the item his seal and the notion "altered by" followed by his signature, the date and a specific description of the alteration.

DRAGON TEA

317 MAMARONECK AVE.		MAMARONECK, NY 10543	
SCALE: 1/4" = 1'-0"		DRAWN BY: dpc	
DATE: Feb. 14, '23		REVISED:	
ZONE C-2	SEC. 9	BLK. 19	LOT 14A1
DRAWING:		1 OF 1	