

# **Chiswell and Associates, LLC**

525-K East Market Street #233 Leesburg, VA 20176 434-589-4446  
www.selfstorageconsulting.com Chiswell@Earthlink.net

## **Self Storage Feasibility Addition Memorandum**

**Mamaroneck Self Storage  
426 Waverly Avenue  
Mamaroneck, New York**



**Prepared Exclusively for**  
**Mr. Chris Murphy / Mr. Sean Murphy**  
**Mamaroneck Self Storage**  
**December, 2017**

Self Storage Feasibility  
Addition Memorandum  
for  
Mamaroneck Self Storage  
426 Waverly Avenue  
Mamaroneck, New York

Table of Contents

Section 1	Executive Summary
Section 2	Demographic – Customer Analysis
Section 3	Competition Evaluation
Section 4	Project Scope - Proposed Expansion
Section 5	Appendix

# Section 1

## Executive Summary

## **Section 1 - Executive Summary**

This Memorandum is designed to review the proposed addition to the Mamaroneck Self Storage complex. Having prepared the initial Self Storage Feasibility Study and Report for the development of the facility, I am uniquely qualified to comment of the proposed addition. In preparing this Evaluation, I examined details of your current operations, the proposed design of the four story addition, proposed Unit Mix, analyzed a site specific demographic report based upon the primary zip codes of your customers, as well as a review of the competition within the target market area.

The current operations have already achieved a Unit Occupancy of 84.48% and a Square Footage Occupancy of 86.98%. In my professional opinion, the addition of the designed 38,950 net square footage, adding 350 more units, will be well received by the community and will quickly lease up.

Within the five primary zip codes that account for 76.02% of your customers, there are currently no existing competitive self storage facilities. This is entirely the result of restrictive zoning within the communities. The ability to once again take advantage of the existing zoning on your Waverly Avenue property without the need to seek any change in the allowed use is a significant advantage. Your design for the addition will result in almost no additional impact on either Waverly Avenue or Fenimore Road. Also, as is the nature of self storage operations, no negative impact is anticipated on either the water or sewer system as a result of the expansion.

Your corporate commitment to the environment, as evident from the various awards the existing building has received, will be duplicated with the new structure. The energy efficiency of your original design was 52% more energy efficient than required by the NYS building code. The same is anticipated in the new structure.

The profile of the residential composition, within the five primary zip codes that you are serving, reflects an Average Household Income of \$192,157. Residents clearly have the disposable income to afford self storage rentals.

Based on all the information collected and reviewed, I feel the addition to Mamaroneck Self Storage will once again be positively received by the communities you are serving and should be developed.

## Section 2

### Demographic – Customer Analysis

## Section 2 - Demographic – Customer Analysis

As I evaluated the feasibility of expanding the current Mamaroneck Self Storage complex, one the vital questions that I sought to answer was where the current customers are coming from that use the facility. The answer to this question provides the “Marketing Reach” of the business.

To obtain accurate results, I analyzed the zip code locations of all 221 customers. These customers are currently renting 245 storage units. Having conducted the initial Feasibility Study for the development of Phase 1 of the facility, I was honestly not surprised by the results shown on the chart below. A total of 76.02% of all current customers are coming from just five nearby zip codes including Mamaroneck - 10543, Larchmont – 10538, Harrison – 10528, Rye – 10580 and New Rochelle – 10804. The remaining customers are coming from other New York State zip codes and totals 18.55% and there are 5.43% of customers coming from outside New York.

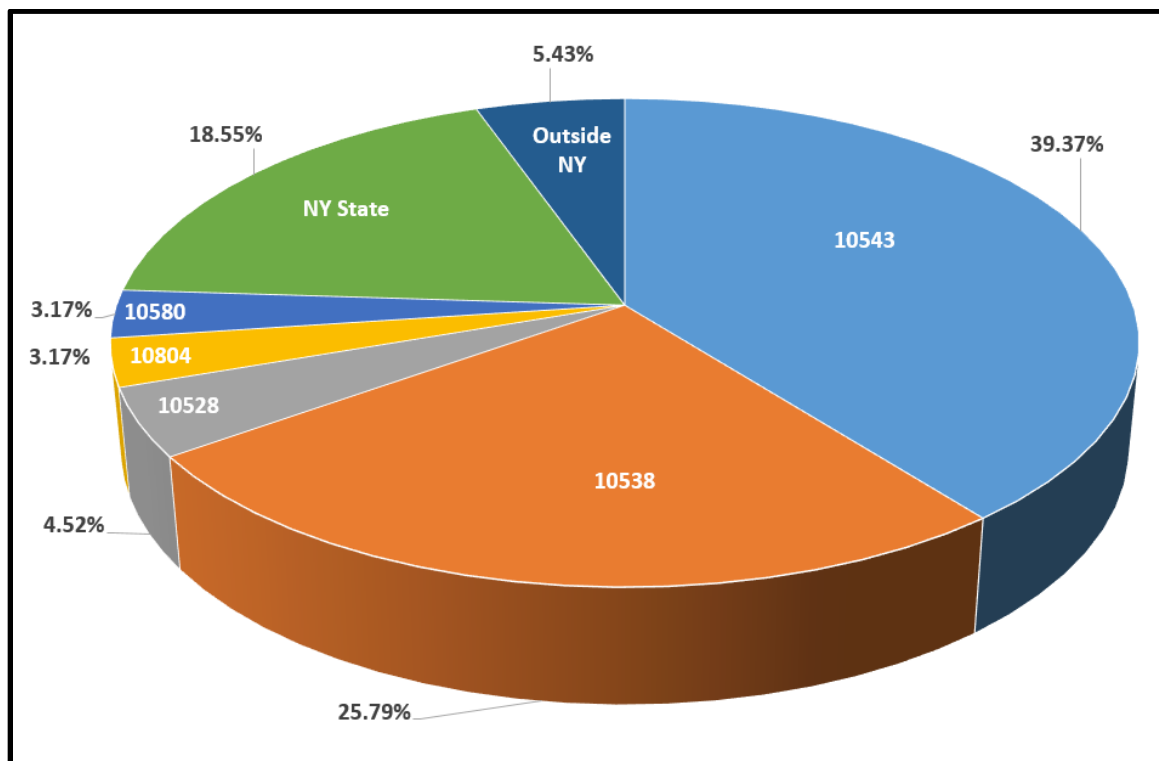

These zip code zones will remain the obvious target market area for the business as it expands. Using the resources of the Environics Analytics Corporation, I commissioned residential demographic reports detailing these five zip codes.

	Mamaroneck	Larchmont	Harrison	Rye	New Rochelle	Totals
Households	8,171	6,430	4,366	11,073	15,994	46,034
Population	21,111	17,208	12,305	30,558	44,541	125,723
Avg HoHld \$	\$148,847	\$222,394	\$169,335	\$206,160	\$214,047	\$192,157

10543 – Mamaroneck



10538 - Larchmont



10528 – Harrison

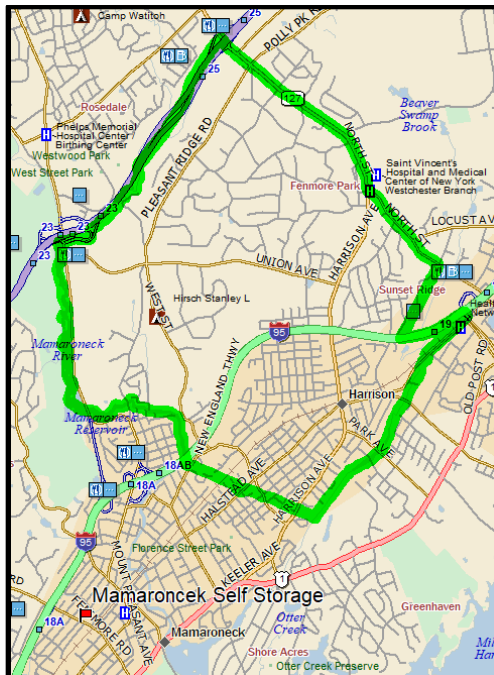

10580 -Rye



## 10804 – New Rochelle

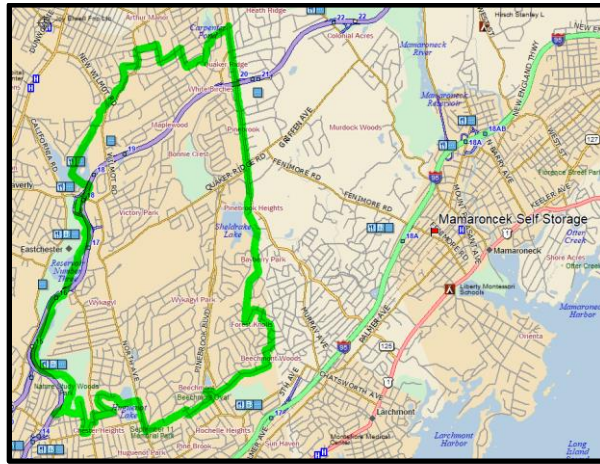

The 2017 national research report revealed that an average of 10% of the households in the United States currently use self storage. These customers are on average using storage at a rate of approximately 1.3 units per household and the average national unit size is projected to be 120 square feet. In a more urban setting, we have found that the average unit size is closer to 100 square foot average. While the national residential to commercial customer ratio is typically 80% residential 20% commercial, again in a more urban setting it is found to be 90% - 10%.

While the Association's research focused on households as the driver of Demand Potential, some people in the storage industry use a national Per Capita factor currently at 7.0 square feet per person. I have applied these two methodologies to create Demand Potential calculations for the combined five studied areas.

Total Households	46,034
% of Users	10%
Total Users	4,603
Units Per User	1.3
Total Units Used	5,984
Sq Ft of Unit	100
Total Residential Sq Ft = 90%	598,442
Total Business Sq Ft = 10%	66,494
Total Sq Ft Demand Potential	664,936
Population	125,723
7 Sq Ft Per Capita	7
Total Sq Ft Demand Potential	880,061



The Supply Demand ratio for the target market area is very apparent when there are no competitive facilities within the five zip code areas. Removing the current 29,100 sf of existing rentable square footage and the additional proposed 38,950 net rentable square footage of the addition from the national Demand Potential figures still leaves over 500,000 square feet of residential demand within the target market area.

The Average Household Income figures across the five zip code areas of \$192,157 demonstrates that residents in these communities have the disposable income to provide for a monthly storage expense. It may seem counterintuitive, but the national research shows that the average residential storage customer has a garage (most with a two car garage), an attic and or a basement, but still use self storage.

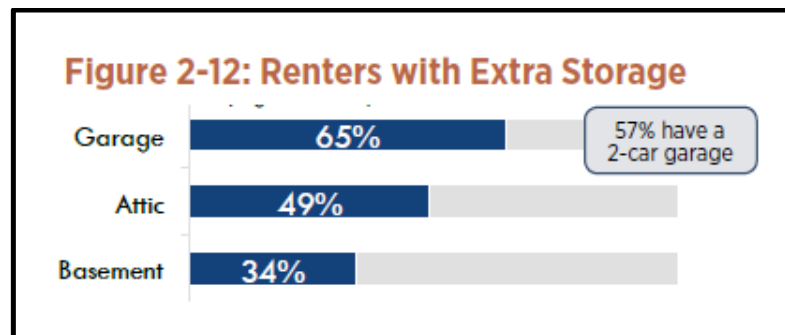

**Figure 2-12, Page 17 Self Storage Demand Study – 2017 Edition**

The analysis of the demographics of the primary zip code areas being served along with a review of current customers, show that there is no question an expansion of the existing Mamaroneck Self Storage facility will be successful.

Copies of the five demographic reports are included in the Appendix of this Memorandum.

## Section 3

### Competition Evaluation

### **Section 3 - Competition Evaluation**

Across the United States, the Self Storage Industry has developed over the past forty years from a niche real estate play into a fully recognized asset class within the broader real estate market place. With 2017 total industry revenues expected to reach \$32 billion, the business has established significant credentials.

There is sufficient self storage structures across the Country, for example, to allow for every woman/man and children to stand under the roof of a storage building. By 2017 nearly 12 million households were using storage as shown on the chart from the national Self Storage Association research.

**Figure 1-1: Total Households vs. Self Storage Renter Households**

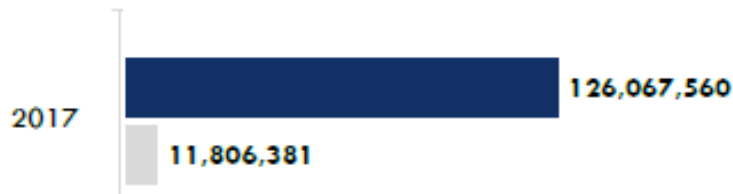

**Figure 1-1, Page 4 Self Storage Demand Study – 2017 Edition**

The vast majority of self storage customers come from single family residences.

**Figure 2-11: Type of Residence**

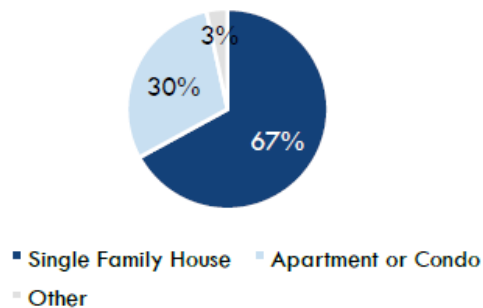

However, Mamaroneck Self Storage is the only facility of its kind from the north end of New Rochelle to the south end of Port Chester, and from Tuckahoe to the Long Island Sound, (as indicated in the attached map) touching all five zip codes that you are working with: 10543/Mamaroneck, 10538/Larchmont, 10580/Rye, 10528/Harrison, 10804/New Rochelle (as well as a large portion of 10583/Scarsdale).

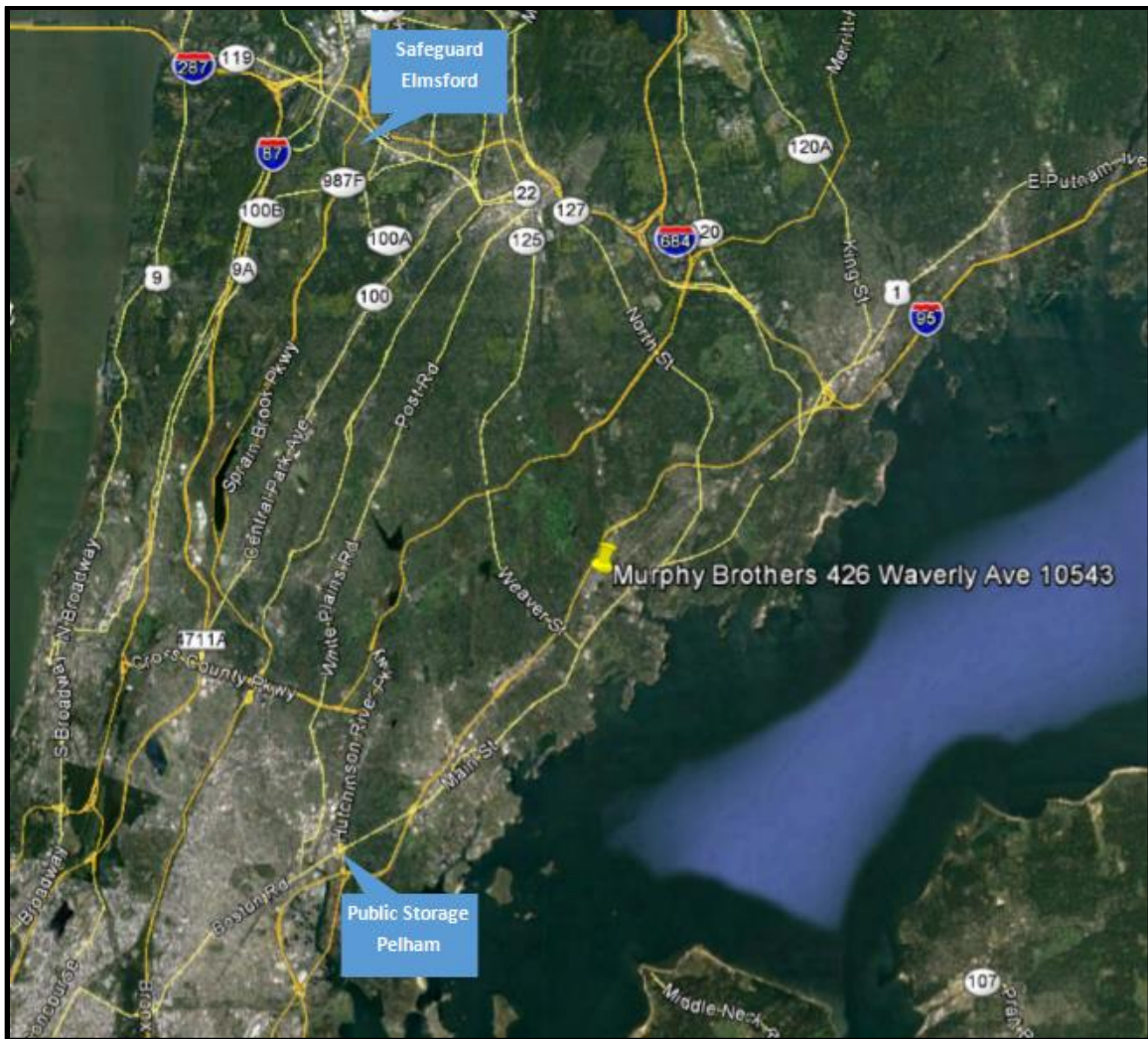

The prevailing zoning use restrictions coupled with the extremely high barriers to entry are significant deterrents to potential competitors who contemplate entering the area. Therefore, it is my professional opinion that competition will not be a negative factor to the future success of the expansion.

## Section 4

### Project Scope - Proposed Expansion

## Section 4 - Project Scope - Proposed Expansion

The proposed addition of 35,150 net square feet of self storage is in direct response to the success that the initial development has enjoyed. This is not only evident from the 84.48% Unit Occupancy and 86.98% square footage occupancy that you currently enjoy, but also from the Average Length of Stay of your customers.

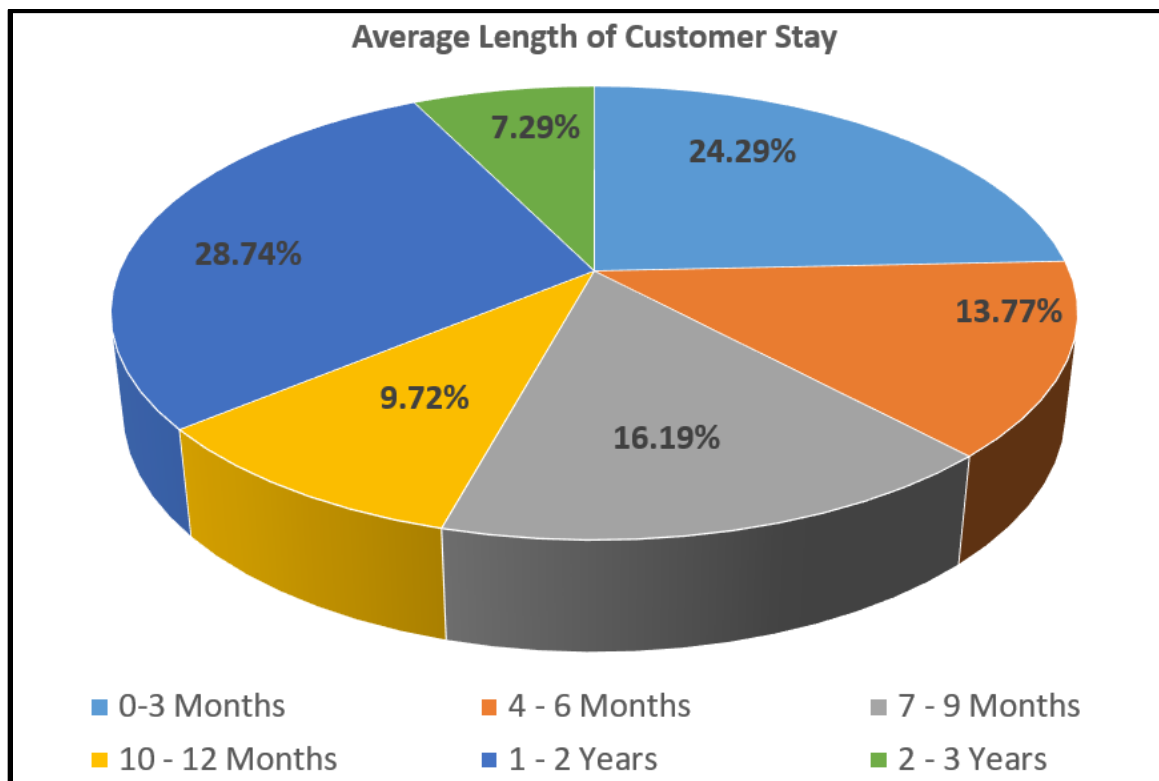

Customer records show that 61.94% of tenants have rented for 6 months or longer and 36.03% have stored for a full year or longer.

The proposed Unit Mix, with an Average Unit Size of 109.5 square feet, is just slightly larger than the original 92.2 square foot average in the current building.

### **Murphy Brothers Addition Unit Mix**

								Total	Total
	Size		Sq Ft	1st Fl	2nd Fl	3rd Fl	4th Fl	Units	Sq Ft
5	x	10	50	12	12	12	12	48	2,400
10	x	10	100	22	60	60	60	202	20,200
10	x	15	150		11	11	11	33	4,950
10	x	20	200	26	4	4	4	38	7,600
								321	35,150





The addition will complement the current structure both exteriorly and internally in its design and material composition.



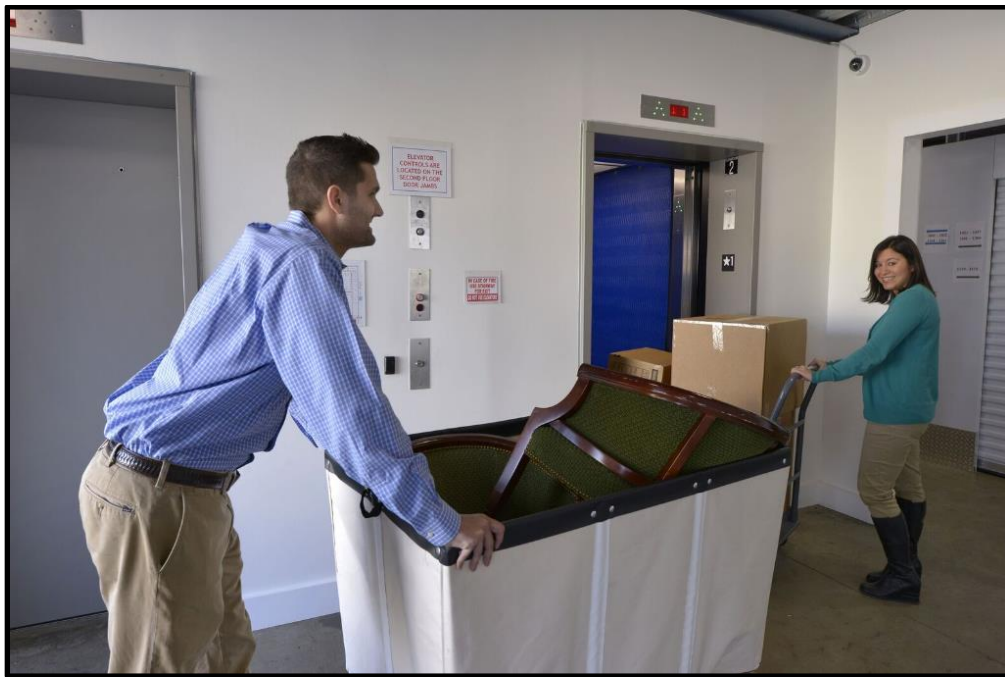

Since the opening of Mamaroneck Self Storage, the facility has received three major awards including: The Best of Building Owners and Managers' Association Westchester County's - Signature Award in the category of "Re-position / Re-purpose Award"; Westchester County 2017 Earth Day Award for the development of Mamaroneck Self Storage with energy-



efficient features built into the facility design and the 2016 HBRA-CT HOBI Award for "Best Green Commercial Project".

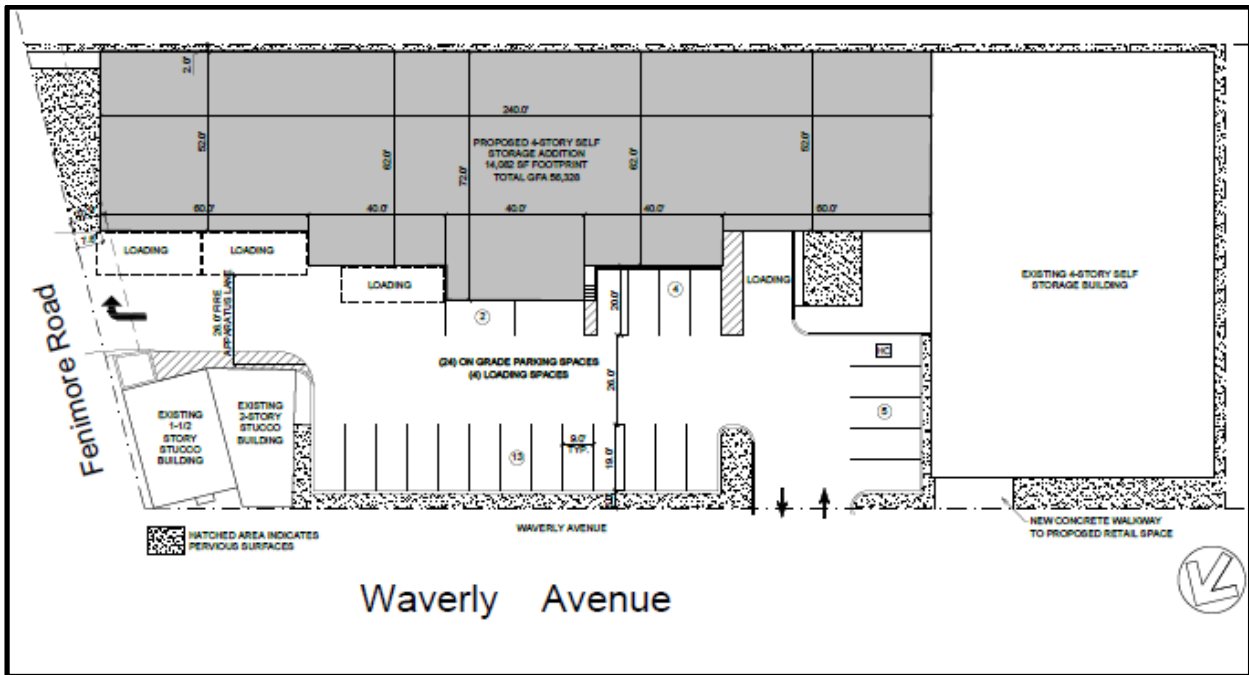

The addition will maximize the potential of the property while minimizing impacts on the surrounding community.

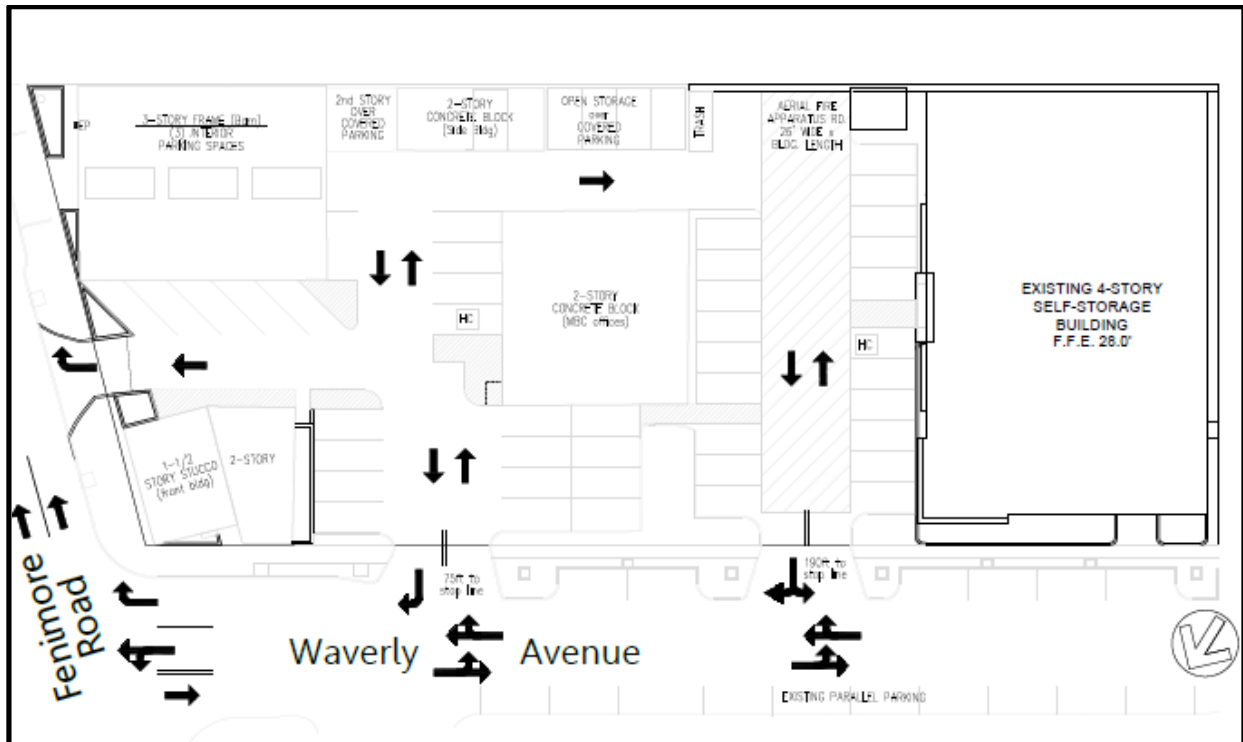

The addition will continue to limit any traffic impacts on both Waverly Avenue and Fenimore Road.

Murphy Brothers Contracting collaborated with local architect, Ms. Kim Martelli and nationally known energy consultants, Steven Winter Associates to construct the initial 40,000 square foot self-storage facility under NYSERDA's New Construction Program to rate better than 52% more energy efficient than required by the NYS building code. The results succeeded in averaging annual operating cost savings of over \$30,000 while providing a NYSERDA rebate check totaling close to \$60,000 for incorporating energy-efficient upgrades into the construction. Identical building techniques will be employed in the construction of the proposed addition.

The redundant security systems that provide a secure environment for customers will be duplicated in the addition. Your Management standard of requiring all customers to provide a Government Issued Photo Identification as a condition for rental has also contributed to the secure atmosphere.

It is evident to me after reviewing the proposed design, Unit Mix and the various customer factors from your current operations that the proposed addition to the existing Mamaroneck Self Storage will provide the community you serve with the additional self storage options that customers have been asking for during the past year, and will continue to need in the future.

## Section 5 Appendix

## **Section 5 - Appendix**

- The Environics Analytics Corporation Background
- Sydney James Chiswell's Self Storage Industry Background
- Five Primary Zip Code Demographic Reports

## **Environics Analytics Demographics Program Overview**

The Environics Analytics Demographic Program traces its history to the industry's earliest years, and newly combined company completing its third decade in the hands of the industry's most experienced demographers. The demographers now with the Environics team did the industry's groundbreaking work in small area estimation, and continue to make contributions to the profession of applied demography.

Environics adapts standard demographic methods to use with the best data at each geographic level. For example, Environics tracks neighborhood-level growth and decline from the annual acquisition of current small-area data from across the nation. Sources include estimates from local governments, consumer database counts, and postal delivery statistics. Such sources allow a "bottom-up" methodology grounded in authoritative local sources. Environics also uses Census Bureau estimates and other federal data to produce highly accurate totals for larger areas such as cities, counties and states. These independent estimates are used as control totals for the small area estimates, thus providing the internal consistency of a "top-down" process. Environics has refined this approach over the past three decades and annually evaluates new data sources and techniques to ensure maximum accuracy.

The Environics Reports are based upon data prepared for the current year, and projections (sometimes called forecasts) are prepared for dates five years in the future. New data updates are produced each year for many geographic levels including national, state, county, place (city/town), MCD, census tract, and block group. Data are also available for commonly used areas such as metropolitan areas, ZIP Codes, and media areas such as DMAs. Because they are produced for small areas, the data can be easily aggregated to custom geographic areas specified by the user.

Pop-Facts starts with the estimation and projection of "base counts," such as total population, household population, group quarters population, households, family households, and housing units. Characteristics related to these base counts are then estimated. Population characteristics include age, sex, race, and Hispanic ethnicity; households are estimated by age of householder and income; family households are estimated by income; and owner-occupied housing units are estimated by value.

**Sydney James Chiswell**  
**Self Storage Industry Background**

Mr. Chiswell has been involved in the self-storage industry for thirty-five years. For the past twenty-seven years, his consulting firm, Chiswell & Associates, has been involved full time in providing consulting services exclusively to the self storage industry. Countless engagements, across the United States, have involved the preparation of Project Feasibility Studies for clients seeking to build new projects and Acquisition Due Diligence Reports for clients who are buying existing self storage facilities.

Prior to starting the firm in 1990, he was Vice President of Acquisitions for Sovran Self Storage (now Life Storage) for six years. During his last two years with Sovran, Chiswell was also responsible for the Facility Management of Sovran's 2 million+ square foot, 34 property portfolio of self-storage facilities in 10 states. Life Storage is now a publicly traded Real Estate Investment Trust (REIT) and one of the top five self-storage companies in America with over 600 properties.

Mr. Chiswell's experience and reputation in the industry has provided him with the opportunity to author a number of articles for industry publications. He is a frequent contributing author for Inside Self Storage magazine and is a member of their Editorial Advisory Board. He is a principle speaker at self storage meetings for Inside Self Storage magazine and at both national and state Self Storage Association conferences and trade shows.

As part of his desire to help provide educational opportunities for self storage owners and managers, Jim is serving as an educational consultant to the Self Storage Training Institute (SSTI). He is a faculty member of SSTI's Qualified Storage Manager certification program. This is the first online certification program available within the self storage industry. Chiswell is also a Founding Moderator of the Self Storage Talk internet forum which has over 9,000 registered self storage owner and manager members from across the world.

# Pop-Facts Demographics Snapshot | Summary

Trade Area: 10543 (Mamaroneck, NY)

	10543 (Mamaroneck, NY) Total	%
<b>Population</b>		
2000 Census	19,712	100.00
2010 Census	20,186	100.00
2017 Estimate	21,111	100.00
2022 Projection	21,766	100.00
<b>Population Growth</b>		
Percent Change: 2000 to 2010	--	2.40
Percent Change: 2010 to 2017	--	4.58
Percent Change: 2017 to 2022	--	3.10
	10543 (Mamaroneck, NY) Total	%
<b>Households</b>		
2000 Census	7,445	100.00
2010 Census	7,462	100.00
2017 Estimate	7,882	100.00
2022 Projection	8,171	100.00
<b>Household Growth</b>		
Percent Change: 2000 to 2010	--	0.23
Percent Change: 2010 to 2017	--	5.63
Percent Change: 2017 to 2022	--	3.67
	10543 (Mamaroneck, NY) Total	%
<b>Family Households</b>		
2000 Census	5,178	100.00
2010 Census	5,088	100.00
2017 Estimate	5,373	100.00
2022 Projection	5,565	100.00
<b>Family Household Growth</b>		
Percent Change: 2000 to 2010	--	-1.74
Percent Change: 2010 to 2017	--	5.60
Percent Change: 2017 to 2022	--	3.57

Benchmark: USA

Copyright © 2017 by Environics Analytics (EA). Source: Claritas - Pop-Facts Premier 2017, .

# Pop-Facts Demographics Snapshot | Population & Race

Trade Area: 10543 (Mamaroneck, NY)

Total Population: 21,111

Total Households: 7,882

	10543 (Mamaroneck, NY) Count	%
<b>2017 Est. Population by Single-Classification Race</b>		
White Alone	15,219	72.09
Black/African American Alone	883	4.18
American Indian/Alaskan Native Alone	55	0.26
Asian Alone	1,315	6.23
Native Hawaiian/Pacific Islander Alone	14	0.07
Some Other Race Alone	2,877	13.63
Two or More Races	748	3.54
<b>2017 Est. Population by Hispanic or Latino Origin</b>		
Not Hispanic or Latino	15,466	73.26
Hispanic or Latino	5,645	26.74
Mexican	1,204	21.33
Puerto Rican	530	9.39
Cuban	105	1.86
All Other Hispanic or Latino	3,806	67.42
<b>2017 Est. Pop by Race, Asian Alone, by Category</b>		
Chinese, except Taiwanese	468	35.59
Filipino	83	6.31
Japanese	363	27.61
Asian Indian	150	11.41
Korean	206	15.66
Vietnamese	0	0.00
Cambodian	0	0.00
Hmong	0	0.00
Laotian	0	0.00
Thai	0	0.00
All Other Asian Races Including 2+ Category	45	3.42
<b>2017 Est. Population by Ancestry</b>		
Arab	134	0.64
Czech	33	0.16
Danish	17	0.08
Dutch	74	0.35
English	488	2.31
French (Excluding Basque)	532	2.52
French Canadian	78	0.37
German	845	4.00
Greek	277	1.31
Hungarian	96	0.46
Irish	1,776	8.41
Italian	4,533	21.47
Lithuanian	25	0.12
Norwegian	36	0.17
Polish	411	1.95
Portuguese	75	0.35
Russian	524	2.48
Scottish	47	0.22
Scotch-Irish	47	0.22
Slovak	0	0.00
Sub-Saharan African	116	0.55
Swedish	81	0.38
Swiss	18	0.09
Ukrainian	74	0.35
United States or American	1,666	7.89
Welsh	23	0.11
West Indian (except Hisp. groups)	298	1.41
Other ancestries	7,208	34.14
Ancestries Unclassified	1,579	7.48
<b>2017 Est. Pop Age 5+ by Language Spoken At Home</b>		
Speak Only English at Home	13,588	68.16
Speak Asian/Pacific Isl. Lang. at Home	866	4.34
Speak Indo-European Language at Home	2,378	11.93
Speak Spanish at Home	2,945	14.77
Speak Other Language at Home	160	0.80
<b>2017 Est. Hisp. or Latino Pop by Single-Class. Race</b>		
White Alone	2,358	41.77
Black/African American Alone	77	1.36
American Indian/Alaskan Native Alone	35	0.62
Asian Alone	5	0.09
Native Hawaiian/Pacific Islander Alone	7	0.12
Some Other Race Alone	2,790	49.42
Two or More Races	373	6.61

Benchmark: USA

Copyright © 2017 by Environics Analytics (EA). Source: Claritas - Pop-Facts Premier 2017, .



# Pop-Facts Demographics Snapshot | Population & Race

Trade Area: 10543 (Mamaroneck, NY)

Total Population: 21,111

Total Households: 7,882

	10543 (Mamaroneck, NY) Count	%
<b>2017 Est. Population by Sex</b>		
Male	10,372	49.13
Female	10,739	50.87
<b>2017 Est. Population by Age</b>		
Age 0 - 4	1,174	5.56
Age 5 - 9	1,246	5.90
Age 10 - 14	1,393	6.60
Age 15 - 17	881	4.17
Age 18 - 20	792	3.75
Age 21 - 24	1,033	4.89
Age 25 - 34	2,370	11.23
Age 35 - 44	2,793	13.23
Age 45 - 54	3,299	15.63
Age 55 - 64	2,772	13.13
Age 65 - 74	1,686	7.99
Age 75 - 84	998	4.73
Age 85 and over	674	3.19
Age 16 and over	17,009	80.57
Age 18 and over	16,417	77.77
Age 21 and over	15,625	74.01
Age 65 and over	3,358	15.91
Median Age	—	41.17
Average Age	—	40.50
<b>2017 Est. Pop Age 15+ by Marital Status</b>		
Total, Never Married	5,347	30.91
Male, Never Married	2,908	16.81
Female, Never Married	2,439	14.10
Married, Spouse Present	8,772	50.71
Married, Spouse Absent	591	3.42
Widowed	1,155	6.68
Male, Widowed	254	1.47
Female, Widowed	901	5.21
Divorced	1,433	8.28
Male, Divorced	428	2.47
Female, Divorced	1,005	5.81
<b>2017 Est. Male Population by Age</b>		
Male: Age 0 - 4	597	5.76
Male: Age 5 - 9	664	6.40
Male: Age 10 - 14	734	7.08
Male: Age 15 - 17	454	4.38
Male: Age 18 - 20	413	3.98
Male: Age 21 - 24	542	5.23
Male: Age 25 - 34	1,257	12.12
Male: Age 35 - 44	1,402	13.52
Male: Age 45 - 54	1,589	15.32
Male: Age 55 - 64	1,319	12.72
Male: Age 65 - 74	777	7.49
Male: Age 75 - 84	402	3.88
Male: Age 85 and over	222	2.14
Median Age, Male	—	38.88
Average Age, Male	—	38.70
<b>2017 Est. Female Population by Age</b>		
Female: Age 0 - 4	577	5.37
Female: Age 5 - 9	582	5.42
Female: Age 10 - 14	659	6.14
Female: Age 15 - 17	427	3.98
Female: Age 18 - 20	379	3.53
Female: Age 21 - 24	491	4.57
Female: Age 25 - 34	1,113	10.36
Female: Age 35 - 44	1,391	12.95
Female: Age 45 - 54	1,710	15.92
Female: Age 55 - 64	1,453	13.53
Female: Age 65 - 74	909	8.46
Female: Age 75 - 84	596	5.55
Female: Age 85 and over	452	4.21
Median Age, Female	—	43.36
Average Age, Female	—	42.10

Benchmark: USA

Copyright © 2017 by Environics Analytics (EA). Source: Claritas - Pop-Facts Premier 2017, .

# Pop-Facts Demographics Snapshot | Housing & Households

Trade Area: 10543 (Mamaroneck, NY)

Total Population: 21,111

Total Households: 7,882

	10543 (Mamaroneck, NY) Count	%
<b>2017 Est. Households by Household Type</b>		
Family Households	5,373	68.17
NonFamily Households	2,509	31.83
<b>2017 Est. Group Quarters Population</b>		
2017 Est. Group Quarters Population	332	1.57
<b>2017 HHs By Ethnicity, Hispanic/Latino</b>		
2017 HHs By Ethnicity, Hispanic/Latino	1,540	19.54
<b>2017 Est. Family HH Type by Presence of Own Child.</b>		
Married Couple Family, own children	2,131	39.66
Married Couple Family, no own children	2,113	39.33
Male Householder, own children	135	2.51
Male Householder, no own children	197	3.67
Female Householder, own children	421	7.83
Female Householder, no own children	376	7.00
<b>2017 Est. Households by Household Size</b>		
1-Person Household	2,171	27.54
2-Person Household	2,207	28.00
3-Person Household	1,315	16.68
4-Person Household	1,252	15.88
5-Person Household	614	7.79
6-Person Household	199	2.52
7-or-more-person	124	1.57
2017 Est. Average Household Size	—	2.64
<b>2017 Est. Households by Number of Vehicles</b>		
No Vehicles	854	10.84
1 Vehicle	2,810	35.65
2 Vehicles	2,780	35.27
3 Vehicles	1,040	13.20
4 Vehicles	333	4.22
5 or more Vehicles	65	0.82
2017 Est. Average Number of Vehicles	—	1.70
<b>2017 Est. Occupied Housing Units by Tenure</b>		
Housing Units, Owner-Occupied	4,733	60.05
Housing Units, Renter-Occupied	3,149	39.95
<b>2017 Owner Occ. HUs: Avg. Length of Residence</b>		
2017 Owner Occ. HUs: Avg. Length of Residence	—	19.60
<b>2017 Renter Occ. HUs: Avg. Length of Residence</b>		
2017 Renter Occ. HUs: Avg. Length of Residence	—	9.50
<b>2017 Est. Owner-Occupied Housing Units by Value</b>		
Value Less than \$20,000	16	0.34
Value \$20,000 - \$39,999	34	0.72
Value \$40,000 - \$59,999	11	0.23
Value \$60,000 - \$79,999	17	0.36
Value \$80,000 - \$99,999	43	0.91
Value \$100,000 - \$149,999	98	2.07
Value \$150,000 - \$199,999	110	2.32
Value \$200,000 - \$299,999	404	8.54
Value \$300,000 - \$399,999	273	5.77
Value \$400,000 - \$499,999	411	8.68
Value \$500,000 - \$749,999	1,309	27.66
Value \$750,000 - \$999,999	902	19.06
Value \$1,000,000 or more	1,105	23.35
2017 Est. Median All Owner-Occupied Housing Value	—	678,724.29

Benchmark: USA

Copyright © 2017 by Environics Analytics (EA). Source: Claritas - Pop-Facts Premier 2017, .

# Pop-Facts Demographics Snapshot | Housing & Households

Trade Area: 10543 (Mamaroneck, NY)

Total Population: 21,111

Total Households: 7,882

	10543 (Mamaroneck, NY) Count	%
<b>2017 Est. Housing Units by Units in Structure</b>		
1 Unit Attached	307	3.65
1 Unit Detached	3,809	45.25
2 Units	1,393	16.55
3 to 4 Units	692	8.22
5 to 19 Units	751	8.92
20 to 49 Units	756	8.98
50 or More Units	697	8.28
Mobile Home or Trailer	13	0.15
Boat, RV, Van, etc.	0	0.00
<b>2017 Est. Housing Units by Year Structure Built</b>		
Built 2010 or Later	477	5.67
Built 2000 to 2009	396	4.70
Built 1990 to 1999	284	3.37
Built 1980 to 1989	515	6.12
Built 1970 to 1979	382	4.54
Built 1960 to 1969	910	10.81
Built 1950 to 1959	1,677	19.92
Built 1940 to 1949	716	8.51
Built 1939 or Earlier	3,061	36.36
<b>2017 Housing Units by Year Structure Built</b>		
2017 Est. Median Year Structure Built	—	1,952.83
<b>2017 Est. Households by Presence of People Under 18</b>		
2017 Est. Households by Presence of People Under 18	2,838	36.01
<b>Households with 1 or More People under Age 18</b>		
Married Couple Family	2,182	76.89
Other Family, Male Householder	161	5.67
Other Family, Female Householder	474	16.70
NonFamily Household, Male Householder	13	0.46
NonFamily Household, Female Householder	8	0.28
<b>Households with No People under Age 18</b>		
Households with No People under Age 18	5,044	63.99
Married Couple Family	2,059	40.82
Other Family, Male Householder	171	3.39
Other Family, Female Householder	324	6.42
NonFamily, Male Householder	990	19.63
NonFamily, Female Householder	1,500	29.74

Benchmark: USA

Copyright © 2017 by Environics Analytics (EA). Source: Claritas - Pop-Facts Premier 2017, .

# Pop-Facts Demographics Snapshot | Affluence & Education

Trade Area: 10543 (Mamaroneck, NY)

Total Population: 21,111

Total Households: 7,882

	10543 (Mamaroneck, NY) Count	%
<b>2017 Est. Pop Age 25+ by Edu. Attainment</b>		
Less than 9th Grade	811	5.56
Some High School, No Diploma	613	4.20
High School Graduate (or GED)	2,637	18.07
Some College, No Degree	2,111	14.47
Associate's Degree	549	3.76
Bachelor's Degree	3,912	26.81
Master's Degree	2,876	19.71
Professional Degree	795	5.45
Doctorate Degree	288	1.97
<b>2017 Est. Pop Age 25+ by Edu. Attain., Hisp./Lat.</b>		
High School Diploma	939	27.38
High School Graduate	889	25.92
Some College or Associate's Degree	880	25.66
Bachelor's Degree or Higher	722	21.05
<b>2017 Est. Households by HH Income</b>		
Income < \$15,000	656	8.32
Income \$15,000 - \$24,999	456	5.79
Income \$25,000 - \$34,999	504	6.39
Income \$35,000 - \$49,999	603	7.65
Income \$50,000 - \$74,999	1,167	14.81
Income \$75,000 - \$99,999	680	8.63
Income \$100,000 - \$124,999	653	8.29
Income \$125,000 - \$149,999	571	7.24
Income \$150,000 - \$199,999	794	10.07
Income \$200,000 - \$249,999	434	5.51
Income \$250,000 - \$499,999	775	9.83
Income \$500,000+	589	7.47
2017 Est. Average Household Income	--	148,847.00
2017 Est. Median Household Income	--	94,935.64
<b>2017 Median HH Inc. by Single-Class. Race or Eth.</b>		
White Alone	--	100,580.69
Black or African American Alone	--	124,584.94
American Indian and Alaskan Native Alone	--	51,633.46
Asian Alone	--	126,590.32
Native Hawaiian and Other Pacific Islander Alone	--	100,000.00
Some Other Race Alone	--	61,064.87
Two or More Races	--	61,583.50
Hispanic or Latino	--	55,708.85
Not Hispanic or Latino	--	117,008.43
<b>2017 Est. Families by Poverty Status</b>		
2017 Families at or Above Poverty	5,048	93.95
2017 Families at or Above Poverty with children	2,404	44.74
2017 Families Below Poverty	325	6.05
2017 Families Below Poverty with children	190	3.54

Benchmark: USA

Copyright © 2017 by Environics Analytics (EA). Source: Claritas - Pop-Facts Premier 2017, .

# Pop-Facts Demographics Snapshot | Employment & Occupation

Trade Area: 10543 (Mamaroneck, NY)

Total Population: 21,111

Total Households: 7,882

	10543 (Mamaroneck, NY)	
	Count	%
<b>2017 Est. Employed Civilian Population 16+ by Occupation Classification</b>		
White Collar	7,480	70.59
Blue Collar	1,447	13.65
Service and Farming	1,670	15.76
<b>2017 Est. Workers Age 16+ by Travel Time to Work</b>		
Less than 15 Minutes	2,393	24.32
15 - 29 Minutes	2,519	25.61
30 - 44 Minutes	1,922	19.54
45 - 59 Minutes	956	9.72
60 or more Minutes	2,048	20.82
2017 Est. Avg Travel Time to Work in Minutes	—	36.00
<b>2017 Est. Workers Age 16+ by Transp. to Work</b>		
2017 Est. Workers Age 16+ by Transp. to Work	10,380	100.00
Drove Alone	6,026	58.05
Carpooled	577	5.56
Public Transport	2,454	23.64
Walked	532	5.13
Bicycle	56	0.54
Other Means	212	2.04
Worked at Home	523	5.04
<b>2017 Est. Civ. Employed Pop 16+ by Class of Worker</b>		
2017 Est. Civ. Employed Pop 16+ by Class of Worker	10,597	100.00
For-Profit Private Workers	6,419	60.57
Non-Profit Private Workers	1,127	10.63
Local Government Workers	1,184	11.17
State Government Workers	183	1.73
Federal Government Workers	118	1.11
Self-Employed Workers	1,564	14.76
Unpaid Family Workers	2	0.02
<b>2017 Est. Civ. Employed Pop 16+ by Occupation</b>		
Architecture/Engineering	65	0.61
Arts/Design/Entertainment/Sports/Media	486	4.59
Building/Grounds Cleaning/Maintenance	544	5.13
Business/Financial Operations	873	8.24
Community/Social Services	176	1.66
Computer/Mathematical	307	2.90
Construction/Extraction	631	5.96
Education/Training/Library	836	7.89
Farming/Fishing/Forestry	1	0.01
Food Preparation/Serving Related	285	2.69
Healthcare Practitioner/Technician	610	5.76
Healthcare Support	98	0.93
Installation/Maintenance/Repair	219	2.07
Legal	258	2.44
Life/Physical/Social Science	128	1.21
Management	1,690	15.95
Office/Administrative Support	1,003	9.46
Production	228	2.15
Protective Services	293	2.77
Sales/Related	1,048	9.89
Personal Care/Service	449	4.24
Transportation/Material Moving	369	3.48
<b>2017 Est. Pop Age 16+ by Employment Status</b>		
In Armed Forces	0	0.00
Civilian - Employed	10,611	62.38
Civilian - Unemployed	891	5.24
Not in Labor Force	5,507	32.38

Benchmark: USA

Copyright © 2017 by Environics Analytics (EA). Source: Claritas - Pop-Facts Premier 2017, .





# Pop-Facts Demographics Snapshot | Summary

Trade Area: 10538 (Larchmont, NY)

	10538 (Larchmont, NY) Total	%
<b>Population</b>		
2000 Census	16,902	100.00
2010 Census	16,819	100.00
2017 Estimate	17,208	100.00
2022 Projection	17,523	100.00
<b>Population Growth</b>		
Percent Change: 2000 to 2010	--	-0.49
Percent Change: 2010 to 2017	--	2.31
Percent Change: 2017 to 2022	--	1.83

	10538 (Larchmont, NY) Total	%
<b>Households</b>		
2000 Census	6,313	100.00
2010 Census	6,245	100.00
2017 Estimate	6,430	100.00
2022 Projection	6,570	100.00
<b>Household Growth</b>		
Percent Change: 2000 to 2010	--	-1.08
Percent Change: 2010 to 2017	--	2.96
Percent Change: 2017 to 2022	--	2.18

	10538 (Larchmont, NY) Total	%
<b>Family Households</b>		
2000 Census	4,648	100.00
2010 Census	4,557	100.00
2017 Estimate	4,676	100.00
2022 Projection	4,768	100.00
<b>Family Household Growth</b>		
Percent Change: 2000 to 2010	--	-1.96
Percent Change: 2010 to 2017	--	2.61
Percent Change: 2017 to 2022	--	1.97

Benchmark: USA

Copyright © 2017 by Environics Analytics (EA). Source: Claritas - Pop-Facts Premier 2017, .

# Pop-Facts Demographics Snapshot | Population & Race

Trade Area: 10538 (Larchmont, NY)

Total Population: 17,208

Total Households: 6,430

	10538 (Larchmont, NY) Count	%
<b>2017 Est. Population by Single-Classification Race</b>		
White Alone	15,297	88.89
Black/African American Alone	398	2.31
American Indian/Alaskan Native Alone	22	0.13
Asian Alone	678	3.94
Native Hawaiian/Pacific Islander Alone	2	0.01
Some Other Race Alone	332	1.93
Two or More Races	479	2.78
<b>2017 Est. Population by Hispanic or Latino Origin</b>		
Not Hispanic or Latino	15,803	91.83
Hispanic or Latino	1,405	8.16
Mexican	232	16.51
Puerto Rican	279	19.86
Cuban	94	6.69
All Other Hispanic or Latino	800	56.94
<b>2017 Est. Pop by Race, Asian Alone, by Category</b>		
Chinese, except Taiwanese	135	19.91
Filipino	71	10.47
Japanese	276	40.71
Asian Indian	101	14.90
Korean	61	9.00
Vietnamese	0	0.00
Cambodian	0	0.00
Hmong	0	0.00
Laotian	0	0.00
Thai	2	0.29
All Other Asian Races Including 2+ Category	32	4.72
<b>2017 Est. Population by Ancestry</b>		
Arab	95	0.55
Czech	99	0.57
Danish	107	0.62
Dutch	60	0.35
English	852	4.95
French (Excluding Basque)	670	3.89
French Canadian	41	0.24
German	827	4.81
Greek	81	0.47
Hungarian	81	0.47
Irish	1,802	10.47
Italian	1,736	10.09
Lithuanian	91	0.53
Norwegian	160	0.93
Polish	647	3.76
Portuguese	87	0.51
Russian	783	4.55
Scottish	340	1.98
Scotch-Irish	101	0.59
Slovak	11	0.06
Sub-Saharan African	9	0.05
Swedish	64	0.37
Swiss	1	0.01
Ukrainian	30	0.17
United States or American	1,791	10.41
Welsh	57	0.33
West Indian (except Hisp. groups)	58	0.34
Other ancestries	4,811	27.96
Ancestries Unclassified	1,716	9.97
<b>2017 Est. Pop Age 5+ by Language Spoken At Home</b>		
Speak Only English at Home	12,951	80.59
Speak Asian/Pacific Isl. Lang. at Home	362	2.25
Speak Indo-European Language at Home	1,766	10.99
Speak Spanish at Home	684	4.26
Speak Other Language at Home	307	1.91
<b>2017 Est. Hisp. or Latino Pop by Single-Class. Race</b>		
White Alone	987	70.25
Black/African American Alone	40	2.85
American Indian/Alaskan Native Alone	14	1.00
Asian Alone	1	0.07
Native Hawaiian/Pacific Islander Alone	0	0.00
Some Other Race Alone	259	18.43
Two or More Races	104	7.40

Benchmark: USA

Copyright © 2017 by Environics Analytics (EA). Source: Claritas - Pop-Facts Premier 2017, .



# Pop-Facts Demographics Snapshot | Population & Race

Trade Area: 10538 (Larchmont, NY)

Total Population: 17,208

Total Households: 6,430

	10538 (Larchmont, NY) Count	%
<b>2017 Est. Population by Sex</b>		
Male	8,314	48.31
Female	8,894	51.69
<b>2017 Est. Population by Age</b>		
Age 0 - 4	1,138	6.61
Age 5 - 9	1,328	7.72
Age 10 - 14	1,419	8.25
Age 15 - 17	821	4.77
Age 18 - 20	699	4.06
Age 21 - 24	826	4.80
Age 25 - 34	1,140	6.63
Age 35 - 44	1,872	10.88
Age 45 - 54	2,734	15.89
Age 55 - 64	2,424	14.09
Age 65 - 74	1,553	9.03
Age 75 - 84	820	4.76
Age 85 and over	434	2.52
Age 16 and over	13,051	75.84
Age 18 and over	12,502	72.65
Age 21 and over	11,803	68.59
Age 65 and over	2,807	16.31
Median Age	—	42.04
Average Age	—	39.50
<b>2017 Est. Pop Age 15+ by Marital Status</b>		
Total, Never Married	3,107	23.32
Male, Never Married	1,563	11.73
Female, Never Married	1,544	11.59
Married, Spouse Present	8,461	63.51
Married, Spouse Absent	361	2.71
Widowed	625	4.69
Male, Widowed	103	0.77
Female, Widowed	522	3.92
Divorced	769	5.77
Male, Divorced	289	2.17
Female, Divorced	480	3.60
<b>2017 Est. Male Population by Age</b>		
Male: Age 0 - 4	581	6.99
Male: Age 5 - 9	682	8.20
Male: Age 10 - 14	724	8.71
Male: Age 15 - 17	422	5.08
Male: Age 18 - 20	365	4.39
Male: Age 21 - 24	430	5.17
Male: Age 25 - 34	574	6.90
Male: Age 35 - 44	886	10.66
Male: Age 45 - 54	1,287	15.48
Male: Age 55 - 64	1,145	13.77
Male: Age 65 - 74	724	8.71
Male: Age 75 - 84	336	4.04
Male: Age 85 and over	158	1.90
Median Age, Male	—	39.77
Average Age, Male	—	38.10
<b>2017 Est. Female Population by Age</b>		
Female: Age 0 - 4	557	6.26
Female: Age 5 - 9	646	7.26
Female: Age 10 - 14	695	7.81
Female: Age 15 - 17	399	4.49
Female: Age 18 - 20	334	3.75
Female: Age 21 - 24	396	4.45
Female: Age 25 - 34	566	6.36
Female: Age 35 - 44	986	11.09
Female: Age 45 - 54	1,447	16.27
Female: Age 55 - 64	1,279	14.38
Female: Age 65 - 74	829	9.32
Female: Age 75 - 84	484	5.44
Female: Age 85 and over	276	3.10
Median Age, Female	—	43.89
Average Age, Female	—	40.90

Benchmark: USA

Copyright © 2017 by Environics Analytics (EA). Source: Claritas - Pop-Facts Premier 2017, .

# Pop-Facts Demographics Snapshot | Housing & Households

Trade Area: 10538 (Larchmont, NY)

Total Population: 17,208

Total Households: 6,430

	10538 (Larchmont, NY)	
	Count	%
<b>2017 Est. Households by Household Type</b>		
Family Households	4,676	72.72
NonFamily Households	1,754	27.28
<b>2017 Est. Group Quarters Population</b>		
2017 Est. Group Quarters Population	102	0.59
<b>2017 HHs By Ethnicity, Hispanic/Latino</b>		
2017 HHs By Ethnicity, Hispanic/Latino	462	7.18
<b>2017 Est. Family HH Type by Presence of Own Child.</b>		
Married Couple Family, own children	2,279	48.74
Married Couple Family, no own children	1,823	38.99
Male Householder, own children	57	1.22
Male Householder, no own children	83	1.77
Female Householder, own children	228	4.88
Female Householder, no own children	206	4.41
<b>2017 Est. Households by Household Size</b>		
1-Person Household	1,596	24.82
2-Person Household	1,870	29.08
3-Person Household	989	15.38
4-Person Household	1,264	19.66
5-Person Household	566	8.80
6-Person Household	116	1.80
7-or-more-person	29	0.45
2017 Est. Average Household Size	—	2.66
<b>2017 Est. Households by Number of Vehicles</b>		
No Vehicles	258	4.01
1 Vehicle	2,571	39.98
2 Vehicles	2,654	41.27
3 Vehicles	801	12.46
4 Vehicles	145	2.25
5 or more Vehicles	1	0.02
2017 Est. Average Number of Vehicles	—	1.70
<b>2017 Est. Occupied Housing Units by Tenure</b>		
Housing Units, Owner-Occupied	5,005	77.84
Housing Units, Renter-Occupied	1,425	22.16
<b>2017 Owner Occ. HUs: Avg. Length of Residence</b>		
2017 Owner Occ. HUs: Avg. Length of Residence	—	17.10
<b>2017 Renter Occ. HUs: Avg. Length of Residence</b>		
2017 Renter Occ. HUs: Avg. Length of Residence	—	9.90
<b>2017 Est. Owner-Occupied Housing Units by Value</b>		
Value Less than \$20,000	35	0.70
Value \$20,000 - \$39,999	5	0.10
Value \$40,000 - \$59,999	11	0.22
Value \$60,000 - \$79,999	3	0.06
Value \$80,000 - \$99,999	34	0.68
Value \$100,000 - \$149,999	63	1.26
Value \$150,000 - \$199,999	226	4.51
Value \$200,000 - \$299,999	174	3.48
Value \$300,000 - \$399,999	155	3.10
Value \$400,000 - \$499,999	108	2.16
Value \$500,000 - \$749,999	623	12.45
Value \$750,000 - \$999,999	1,260	25.18
Value \$1,000,000 or more	2,308	46.11
2017 Est. Median All Owner-Occupied Housing Value	—	989,947.95

Benchmark: USA

Copyright © 2017 by Environics Analytics (EA). Source: Claritas - Pop-Facts Premier 2017, .

# Pop-Facts Demographics Snapshot | Housing & Households

Trade Area: 10538 (Larchmont, NY)

Total Population: 17,208

Total Households: 6,430

	10538 (Larchmont, NY)	
	Count	%
<b>2017 Est. Housing Units by Units in Structure</b>		
1 Unit Attached	112	1.65
1 Unit Detached	4,245	62.70
2 Units	109	1.61
3 to 4 Units	181	2.67
5 to 19 Units	212	3.13
20 to 49 Units	734	10.84
50 or More Units	1,137	16.80
Mobile Home or Trailer	40	0.59
Boat, RV, Van, etc.	0	0.00
<b>2017 Est. Housing Units by Year Structure Built</b>		
Built 2010 or Later	231	3.41
Built 2000 to 2009	91	1.34
Built 1990 to 1999	99	1.46
Built 1980 to 1989	205	3.03
Built 1970 to 1979	298	4.40
Built 1960 to 1969	620	9.16
Built 1950 to 1959	855	12.63
Built 1940 to 1949	546	8.06
Built 1939 or Earlier	3,825	56.50
<b>2017 Housing Units by Year Structure Built</b>		
2017 Est. Median Year Structure Built	—	1,939.74
<b>2017 Est. Households by Presence of People Under 18</b>		
2017 Est. Households by Presence of People Under 18	2,621	40.76
<b>Households with 1 or More People under Age 18</b>		
Married Couple Family	2,296	87.60
Other Family, Male Householder	66	2.52
Other Family, Female Householder	254	9.69
NonFamily Household, Male Householder	4	0.15
NonFamily Household, Female Householder	1	0.04
<b>Households with No People under Age 18</b>		
Households with No People under Age 18	3,809	59.24
Married Couple Family	1,806	47.41
Other Family, Male Householder	76	2.00
Other Family, Female Householder	178	4.67
NonFamily, Male Householder	609	15.99
NonFamily, Female Householder	1,140	29.93

Benchmark: USA

Copyright © 2017 by Environics Analytics (EA). Source: Claritas - Pop-Facts Premier 2017, .

# Pop-Facts Demographics Snapshot | Affluence & Education

Trade Area: 10538 (Larchmont, NY)

Total Population: 17,208

Total Households: 6,430

	10538 (Larchmont, NY)	
	Count	%
<b>2017 Est. Pop Age 25+ by Edu. Attainment</b>		
Less than 9th Grade	190	1.73
Some High School, No Diploma	196	1.79
High School Graduate (or GED)	825	7.52
Some College, No Degree	905	8.24
Associate's Degree	343	3.13
Bachelor's Degree	4,208	38.34
Master's Degree	2,624	23.91
Professional Degree	1,231	11.21
Doctorate Degree	455	4.14
<b>2017 Est. Pop Age 25+ by Edu. Attain., Hisp./Lat.</b>		
High School Diploma	29	3.42
High School Graduate	83	9.78
Some College or Associate's Degree	235	27.68
Bachelor's Degree or Higher	502	59.13
<b>2017 Est. Households by HH Income</b>		
Income < \$15,000	202	3.14
Income \$15,000 - \$24,999	180	2.80
Income \$25,000 - \$34,999	194	3.02
Income \$35,000 - \$49,999	305	4.74
Income \$50,000 - \$74,999	771	11.99
Income \$75,000 - \$99,999	597	9.29
Income \$100,000 - \$124,999	544	8.46
Income \$125,000 - \$149,999	351	5.46
Income \$150,000 - \$199,999	743	11.55
Income \$200,000 - \$249,999	449	6.98
Income \$250,000 - \$499,999	977	15.19
Income \$500,000+	1,117	17.37
2017 Est. Average Household Income	—	222,394.00
2017 Est. Median Household Income	—	154,652.90
<b>2017 Median HH Inc. by Single-Class. Race or Eth.</b>		
White Alone	—	185,624.29
Black or African American Alone	—	64,810.06
American Indian and Alaskan Native Alone	—	75,000.00
Asian Alone	—	200,000.35
Native Hawaiian and Other Pacific Islander Alone	—	19,874.37
Some Other Race Alone	—	72,208.65
Two or More Races	—	80,388.54
Hispanic or Latino	—	76,637.62
Not Hispanic or Latino	—	190,525.11
<b>2017 Est. Families by Poverty Status</b>		
2017 Families at or Above Poverty	4,556	97.43
2017 Families at or Above Poverty with children	2,533	54.17
2017 Families Below Poverty	120	2.57
2017 Families Below Poverty with children	92	1.97

Benchmark: USA

Copyright © 2017 by Environics Analytics (EA). Source: Claritas - Pop-Facts Premier 2017, .

# Pop-Facts Demographics Snapshot | Employment & Occupation

Trade Area: 10538 (Larchmont, NY)

Total Population: 17,208

Total Households: 6,430

	10538 (Larchmont, NY) Count	%
<b>2017 Est. Employed Civilian Population 16+ by Occupation Classification</b>		
White Collar	7,263	87.02
Blue Collar	385	4.61
Service and Farming	698	8.36
<b>2017 Est. Workers Age 16+ by Travel Time to Work</b>		
Less than 15 Minutes	1,051	14.19
15 - 29 Minutes	1,080	14.58
30 - 44 Minutes	1,763	23.80
45 - 59 Minutes	1,559	21.05
60 or more Minutes	1,955	26.39
2017 Est. Avg Travel Time to Work in Minutes	—	45.00
<b>2017 Est. Workers Age 16+ by Transp. to Work</b>		
2017 Est. Workers Age 16+ by Transp. to Work	8,188	100.00
Drove Alone	3,376	41.23
Carpooled	312	3.81
Public Transport	3,374	41.21
Walked	194	2.37
Bicycle	12	0.15
Other Means	93	1.14
Worked at Home	827	10.10
<b>2017 Est. Civ. Employed Pop 16+ by Class of Worker</b>		
2017 Est. Civ. Employed Pop 16+ by Class of Worker	8,346	100.00
For-Profit Private Workers	5,133	61.50
Non-Profit Private Workers	867	10.39
Local Government Workers	695	8.33
State Government Workers	172	2.06
Federal Government Workers	146	1.75
Self-Employed Workers	1,319	15.80
Unpaid Family Workers	14	0.17
<b>2017 Est. Civ. Employed Pop 16+ by Occupation</b>		
Architecture/Engineering	98	1.17
Arts/Design/Entertainment/Sports/Media	544	6.52
Building/Grounds Cleaning/Maintenance	96	1.15
Business/Financial Operations	1,099	13.17
Community/Social Services	164	1.97
Computer/Mathematical	145	1.74
Construction/Extraction	149	1.78
Education/Training/Library	956	11.46
Farming/Fishing/Forestry	1	0.01
Food Preparation/Serving Related	42	0.50
Healthcare Practitioner/Technician	345	4.13
Healthcare Support	62	0.74
Installation/Maintenance/Repair	108	1.29
Legal	461	5.52
Life/Physical/Social Science	132	1.58
Management	1,632	19.55
Office/Administrative Support	586	7.02
Production	85	1.02
Protective Services	109	1.31
Sales/Related	1,101	13.19
Personal Care/Service	388	4.65
Transportation/Material Moving	43	0.52
<b>2017 Est. Pop Age 16+ by Employment Status</b>		
In Armed Forces	15	0.12
Civilian - Employed	8,320	63.75
Civilian - Unemployed	472	3.62
Not in Labor Force	4,244	32.52

Benchmark: USA

Copyright © 2017 by Environics Analytics (EA). Source: Claritas - Pop-Facts Premier 2017, .

# Pop-Facts Demographics Snapshot | Map

Trade Area: 10538 (Larchmont, NY)

Total Population: 17,208

Total Households: 6,430

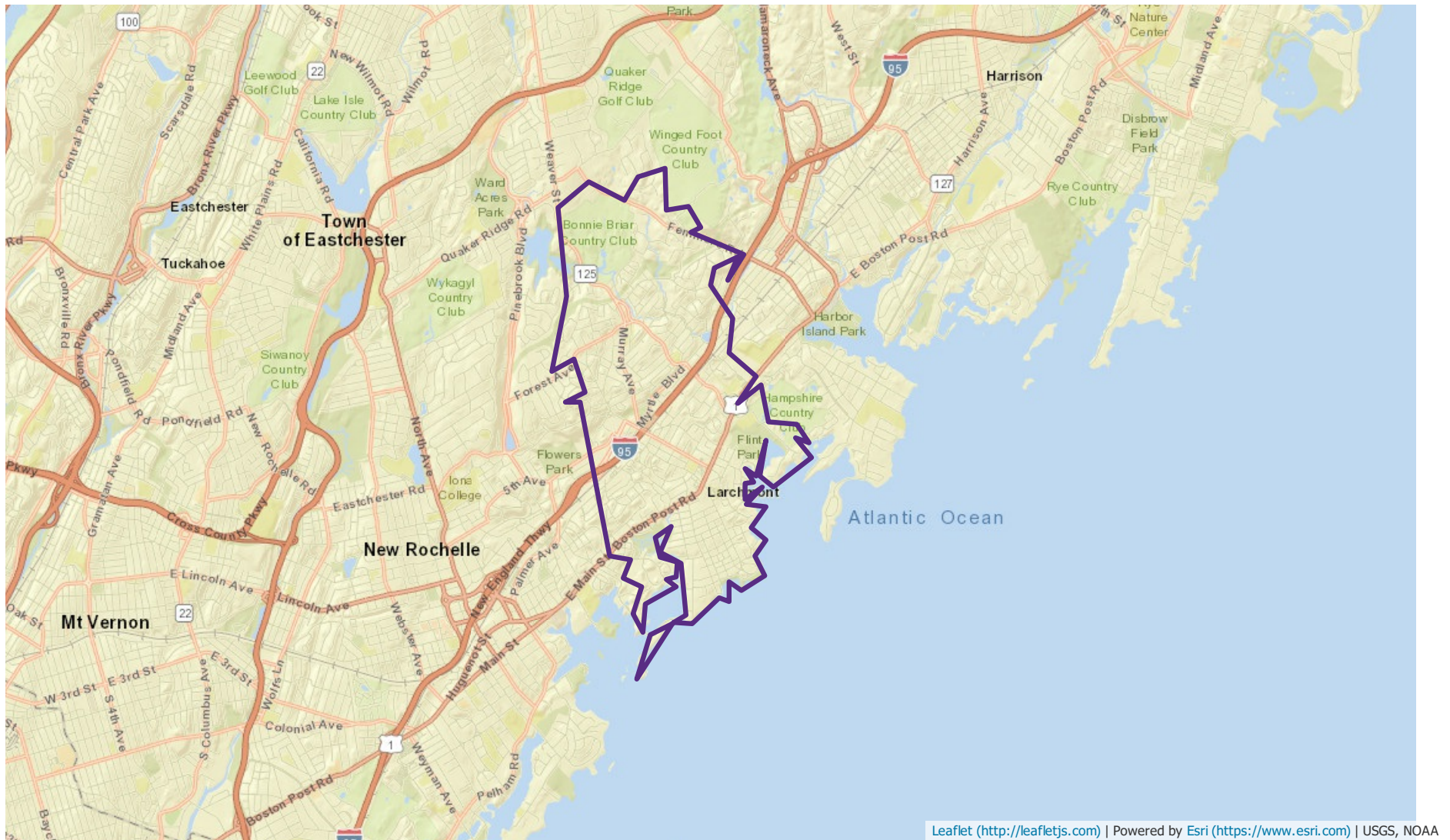



# Pop-Facts Demographics Snapshot | Summary

Trade Area: 10528 (Harrison, NY), 10580 Rye, NY, 10804 New Rochelle

	10528 (Harrison, NY)		10580 Rye, NY		10804 New Rochelle	
	Total	%	Total	%	Total	%
<b>Population</b>						
2000 Census	12,122	100.00	28,831	100.00	42,761	100.00
2010 Census	11,988	100.00	29,483	100.00	43,318	100.00
2017 Estimate	12,305	100.00	30,568	100.00	44,541	100.00
2022 Projection	12,555	100.00	31,357	100.00	45,470	100.00
<b>Population Growth</b>						
Percent Change: 2000 to 2010	—	-1.10	—	2.26	—	1.30
Percent Change: 2010 to 2017	—	2.64	—	3.65	—	2.82
Percent Change: 2017 to 2022	—	2.03	—	2.62	—	2.09

	10528 (Harrison, NY)		10580 Rye, NY		10804 New Rochelle	
	Total	%	Total	%	Total	%
<b>Households</b>						
2000 Census	4,554	100.00	10,529	100.00	15,299	100.00
2010 Census	4,465	100.00	10,588	100.00	15,431	100.00
2017 Estimate	4,633	100.00	11,073	100.00	15,994	100.00
2022 Projection	4,754	100.00	11,414	100.00	16,394	100.00
<b>Household Growth</b>						
Percent Change: 2000 to 2010	—	-1.95	—	0.56	—	0.86
Percent Change: 2010 to 2017	—	3.76	—	4.58	—	3.65
Percent Change: 2017 to 2022	—	2.61	—	3.08	—	2.50

	10528 (Harrison, NY)		10580 Rye, NY		10804 New Rochelle	
	Total	%	Total	%	Total	%
<b>Family Households</b>						
2000 Census	3,324	100.00	7,816	100.00	11,745	100.00
2010 Census	3,239	100.00	7,770	100.00	11,620	100.00
2017 Estimate	3,351	100.00	8,102	100.00	12,011	100.00
2022 Projection	3,433	100.00	8,337	100.00	12,291	100.00
<b>Family Household Growth</b>						
Percent Change: 2000 to 2010	—	-2.56	—	-0.59	—	-1.06
Percent Change: 2010 to 2017	—	3.46	—	4.27	—	3.37
Percent Change: 2017 to 2022	—	2.45	—	2.90	—	2.33

Benchmark: USA

Copyright © 2017 by Environics Analytics (EA). Source: Claritas - Pop-Facts Premier 2017, .

# Pop-Facts Demographics Snapshot | Population & Race

Trade Area: 10528 (Harrison, NY), 10580 Rye, NY, 10804 New Rochelle

Total Population: 12,305, 30,558, 44,541

Total Households: 4,633, 11,073, 15,994

	10528 (Harrison, NY)		10580 Rye, NY		10804 New Rochelle	
	Count	%	Count	%	Count	%
<b>2017 Est. Population by Single-Classification Race</b>						
White Alone	9,944	80.81	26,064	85.29	37,722	84.69
Black/African American Alone	175	1.42	477	1.56	1,623	3.64
American Indian/Alaskan Native Alone	38	0.31	67	0.22	73	0.16
Asian Alone	1,308	10.63	2,477	8.11	3,172	7.12
Native Hawaiian/Pacific Islander Alone	2	0.02	3	0.01	12	0.03
Some Other Race Alone	524	4.26	760	2.49	913	2.05
Two or More Races	314	2.55	710	2.32	1,026	2.30
<b>2017 Est. Population by Hispanic or Latino Origin</b>						
Not Hispanic or Latino	10,836	88.06	27,760	90.84	40,892	91.81
Hispanic or Latino	1,469	11.94	2,798	9.16	3,649	8.19
Mexican	287	19.54	520	18.59	626	17.16
Puerto Rican	296	20.15	539	19.26	761	20.86
Cuban	34	2.31	144	5.15	207	5.67
All Other Hispanic or Latino	852	58.00	1,595	57.01	2,055	56.32
<b>2017 Est. Pop by Race, Asian Alone, by Category</b>						
Chinese, except Taiwanese	73	5.58	323	13.04	534	16.84
Filipino	18	1.38	92	3.71	131	4.13
Japanese	869	66.44	1,472	59.43	1,520	47.92
Asian Indian	160	12.23	291	11.75	506	15.95
Korean	86	6.58	111	4.48	197	6.21
Vietnamese	0	0.00	0	0.00	17	0.54
Cambodian	0	0.00	19	0.77	19	0.60
Hmong	0	0.00	1	0.04	1	0.03
Laotian	0	0.00	0	0.00	0	0.00
Thai	0	0.00	10	0.40	19	0.60
All Other Asian Races Including 2+ Category	102	7.80	158	6.38	228	7.19
<b>2017 Est. Population by Ancestry</b>						
Arab	164	1.33	446	1.46	499	1.12
Czech	0	0.00	1	0.00	76	0.17
Danish	13	0.11	45	0.15	45	0.10
Dutch	10	0.08	135	0.44	136	0.30
English	191	1.55	1,362	4.46	1,560	3.50
French (Excluding Basque)	110	0.89	248	0.81	609	1.37
French Canadian	0	0.00	9	0.03	16	0.04
German	423	3.44	1,816	5.94	2,230	5.01
Greek	82	0.67	179	0.59	311	0.70
Hungarian	40	0.33	103	0.34	275	0.62
Irish	885	7.19	3,111	10.18	4,008	9.00
Italian	3,049	24.78	5,491	17.97	7,826	17.57
Lithuanian	75	0.61	216	0.71	282	0.63
Norwegian	36	0.29	104	0.34	126	0.28
Polish	175	1.42	568	1.86	1,576	3.54
Portuguese	21	0.17	84	0.28	198	0.45
Russian	385	3.13	972	3.18	1,945	4.37
Scottish	90	0.73	208	0.68	258	0.58
Scotch-Irish	35	0.28	55	0.18	62	0.14
Slovak	1	0.01	39	0.13	41	0.09
Sub-Saharan African	146	1.19	160	0.52	217	0.49
Swedish	47	0.38	170	0.56	290	0.65
Swiss	0	0.00	33	0.11	58	0.13
Ukrainian	29	0.24	84	0.28	127	0.28
United States or American	1,165	9.47	3,629	11.88	4,821	10.82
Welsh	10	0.08	15	0.05	34	0.08
West Indian (except Hisp. groups)	0	0.00	76	0.25	417	0.94
Other ancestries	4,075	33.12	8,450	27.65	12,262	27.53
Ancestries Unclassified	1,048	8.52	2,749	9.00	4,236	9.51
<b>2017 Est. Pop Age 5+ by Language Spoken At Home</b>						
Speak Only English at Home	7,543	64.89	21,231	74.08	31,880	76.22
Speak Asian/Pacific Isl. Lang. at Home	1,334	11.48	2,063	7.20	2,366	5.66
Speak Indo-European Language at Home	1,285	11.05	2,686	9.37	4,003	9.57
Speak Spanish at Home	1,186	10.20	2,100	7.33	2,839	6.79
Speak Other Language at Home	276	2.37	580	2.02	736	1.76
<b>2017 Est. Hisp. or Latino Pop by Single-Class. Race</b>						
White Alone	814	55.41	1,776	63.47	2,344	64.24
Black/African American Alone	25	1.70	65	2.32	122	3.34
American Indian/Alaskan Native Alone	35	2.38	54	1.93	55	1.51
Asian Alone	4	0.27	12	0.43	22	0.60
Native Hawaiian/Pacific Islander Alone	0	0.00	0	0.00	0	0.00
Some Other Race Alone	494	33.63	702	25.09	830	22.75
Two or More Races	97	6.60	189	6.75	276	7.56

Benchmark: USA

Copyright © 2017 by Environics Analytics (EA). Source: Claritas - Pop-Facts Premier 2017, .



# Pop-Facts Demographics Snapshot | Population & Race

Trade Area: 10528 (Harrison, NY), 10580 Rye, NY, 10804 New Rochelle

Total Population: 12,305, 30,558, 44,541

Total Households: 4,633, 11,073, 15,994

	10528 (Harrison, NY)		10580 Rye, NY		10804 New Rochelle	
	Count	%	Count	%	Count	%
<b>2017 Est. Population by Sex</b>						
Male	5,918	48.09	14,737	48.23	21,508	48.29
Female	6,387	51.91	15,821	51.77	23,033	51.71
<b>2017 Est. Population by Age</b>						
Age 0 - 4	681	5.53	1,898	6.21	2,717	6.10
Age 5 - 9	731	5.94	2,098	6.87	2,931	6.58
Age 10 - 14	866	7.04	2,514	8.23	3,519	7.90
Age 15 - 17	550	4.47	1,527	5.00	2,189	4.92
Age 18 - 20	484	3.93	1,325	4.34	1,905	4.28
Age 21 - 24	617	5.01	1,637	5.36	2,370	5.32
Age 25 - 34	1,258	10.22	2,445	8.00	3,581	8.04
Age 35 - 44	1,509	12.26	3,125	10.23	4,319	9.70
Age 45 - 54	1,969	16.00	4,931	16.14	6,897	15.48
Age 55 - 64	1,717	13.95	4,213	13.79	6,411	14.39
Age 65 - 74	1,030	8.37	2,408	7.88	3,936	8.84
Age 75 - 84	603	4.90	1,447	4.74	2,338	5.25
Age 85 and over	290	2.36	990	3.24	1,428	3.21
Age 16 and over	9,842	79.98	23,541	77.04	34,647	77.79
Age 18 and over	9,477	77.02	22,521	73.70	33,185	74.50
Age 21 and over	8,993	73.08	21,196	69.36	31,280	70.23
Age 65 and over	1,923	15.63	4,845	15.86	7,702	17.29
Median Age	—	41.67	—	41.35	—	42.49
Average Age	—	40.30	—	39.58	—	40.37
<b>2017 Est. Pop Age 15+ by Marital Status</b>						
Total, Never Married	2,734	27.27	5,716	23.77	8,351	23.61
Male, Never Married	1,535	15.31	3,072	12.77	4,351	12.30
Female, Never Married	1,199	11.96	2,644	10.99	4,000	11.31
Married, Spouse Present	5,682	56.67	14,493	60.27	21,740	61.46
Married, Spouse Absent	376	3.75	956	3.98	1,252	3.54
Widowed	530	5.29	1,364	5.67	2,096	5.92
Male, Widowed	96	0.96	216	0.90	375	1.06
Female, Widowed	434	4.33	1,148	4.77	1,721	4.87
Divorced	705	7.03	1,519	6.32	1,935	5.47
Male, Divorced	203	2.02	526	2.19	677	1.91
Female, Divorced	502	5.01	993	4.13	1,258	3.56
<b>2017 Est. Male Population by Age</b>						
Male: Age 0 - 4	348	5.88	970	6.58	1,386	6.44
Male: Age 5 - 9	364	6.15	1,051	7.13	1,473	6.85
Male: Age 10 - 14	441	7.45	1,315	8.92	1,844	8.57
Male: Age 15 - 17	269	4.54	779	5.29	1,127	5.24
Male: Age 18 - 20	239	4.04	678	4.60	983	4.57
Male: Age 21 - 24	304	5.14	824	5.59	1,207	5.61
Male: Age 25 - 34	623	10.53	1,191	8.08	1,742	8.10
Male: Age 35 - 44	723	12.22	1,462	9.92	2,003	9.31
Male: Age 45 - 54	949	16.04	2,364	16.04	3,284	15.27
Male: Age 55 - 64	821	13.87	2,053	13.93	3,098	14.40
Male: Age 65 - 74	476	8.04	1,125	7.63	1,848	8.59
Male: Age 75 - 84	251	4.24	597	4.05	1,008	4.69
Male: Age 85 and over	110	1.86	328	2.23	505	2.35
Median Age, Male	—	40.41	—	39.27	—	40.42
Average Age, Male	—	39.30	—	38.16	—	39.02
<b>2017 Est. Female Population by Age</b>						
Female: Age 0 - 4	333	5.21	928	5.87	1,331	5.78
Female: Age 5 - 9	367	5.75	1,047	6.62	1,458	6.33
Female: Age 10 - 14	425	6.65	1,199	7.58	1,675	7.27
Female: Age 15 - 17	281	4.40	748	4.73	1,062	4.61
Female: Age 18 - 20	245	3.84	647	4.09	922	4.00
Female: Age 21 - 24	313	4.90	813	5.14	1,163	5.05
Female: Age 25 - 34	635	9.94	1,254	7.93	1,839	7.98
Female: Age 35 - 44	786	12.31	1,663	10.51	2,316	10.05
Female: Age 45 - 54	1,020	15.97	2,567	16.23	3,613	15.69
Female: Age 55 - 64	896	14.03	2,160	13.65	3,313	14.38
Female: Age 65 - 74	554	8.67	1,283	8.11	2,088	9.06
Female: Age 75 - 84	352	5.51	850	5.37	1,330	5.77
Female: Age 85 and over	180	2.82	662	4.18	923	4.01
Median Age, Female	—	42.79	—	43.01	—	44.10
Average Age, Female	—	41.20	—	40.90	—	41.62

Benchmark: USA

Copyright © 2017 by Environics Analytics (EA). Source: Claritas - Pop-Facts Premier 2017, .

# Pop-Facts Demographics Snapshot | Housing & Households

Trade Area: 10528 (Harrison, NY), 10580 Rye, NY, 10804 New Rochelle

Total Population: 12,305, 30,558, 44,541

Total Households: 4,633, 11,073, 15,994

	10528 (Harrison, NY)		10580 Rye, NY		10804 New Rochelle	
	Count	%	Count	%	Count	%
<b>2017 Est. Households by Household Type</b>						
Family Households	3,351	72.33	8,102	73.17	12,011	75.10
NonFamily Households	1,282	27.67	2,971	26.83	3,983	24.90
<b>2017 Est. Group Quarters Population</b>						
2017 Est. Group Quarters Population	11	0.09	167	0.55	240	0.54
<b>2017 HHs By Ethnicity, Hispanic/Latino</b>						
2017 HHs By Ethnicity, Hispanic/Latino	441	9.52	817	7.38	1,044	6.53
<b>2017 Est. Family HH Type by Presence of Own Child.</b>						
Married Couple Family, own children	1,389	41.45	3,879	47.88	5,528	46.02
Married Couple Family, no own children	1,352	40.35	3,086	38.09	4,933	41.07
Male Householder, own children	46	1.37	107	1.32	135	1.12
Male Householder, no own children	92	2.75	163	2.01	239	1.99
Female Householder, own children	215	6.42	420	5.18	550	4.58
Female Householder, no own children	257	7.67	447	5.52	626	5.21
<b>2017 Est. Households by Household Size</b>						
1-Person Household	1,102	23.79	2,641	23.85	3,559	22.25
2-Person Household	1,361	29.38	3,074	27.76	4,652	29.09
3-Person Household	842	18.17	1,819	16.43	2,668	16.68
4-Person Household	857	18.50	2,088	18.86	2,985	18.66
5-Person Household	343	7.40	1,047	9.46	1,535	9.60
6-Person Household	108	2.33	322	2.91	456	2.85
7-or-more-person	20	0.43	82	0.74	139	0.87
2017 Est. Average Household Size	—	2.65	—	2.74	—	2.77
<b>2017 Est. Households by Number of Vehicles</b>						
No Vehicles	309	6.67	741	6.69	970	6.07
1 Vehicle	1,797	38.79	3,509	31.69	4,633	28.97
2 Vehicles	1,583	34.17	4,679	42.26	7,055	44.11
3 Vehicles	678	14.63	1,559	14.08	2,502	15.64
4 Vehicles	225	4.86	492	4.44	691	4.32
5 or more Vehicles	41	0.89	93	0.84	143	0.89
2017 Est. Average Number of Vehicles	—	1.80	—	1.86	—	1.90
<b>2017 Est. Occupied Housing Units by Tenure</b>						
Housing Units, Owner-Occupied	2,792	60.26	7,540	68.09	12,189	76.21
Housing Units, Renter-Occupied	1,841	39.74	3,533	31.91	3,805	23.79
<b>2017 Owner Occ. HUs: Avg. Length of Residence</b>						
2017 Owner Occ. HUs: Avg. Length of Residence	—	20.80	—	18.65	—	18.97
<b>2017 Renter Occ. HUs: Avg. Length of Residence</b>						
2017 Renter Occ. HUs: Avg. Length of Residence	—	7.70	—	7.35	—	7.52
<b>2017 Est. Owner-Occupied Housing Units by Value</b>						
Value Less than \$20,000	67	2.40	117	1.55	195	1.60
Value \$20,000 - \$39,999	13	0.47	19	0.25	21	0.17
Value \$40,000 - \$59,999	8	0.29	11	0.15	13	0.11
Value \$60,000 - \$79,999	10	0.36	47	0.62	55	0.45
Value \$80,000 - \$99,999	15	0.54	38	0.50	40	0.33
Value \$100,000 - \$149,999	16	0.57	49	0.65	81	0.67
Value \$150,000 - \$199,999	54	1.93	115	1.52	193	1.58
Value \$200,000 - \$299,999	152	5.44	240	3.18	385	3.16
Value \$300,000 - \$399,999	130	4.66	283	3.75	453	3.72
Value \$400,000 - \$499,999	165	5.91	306	4.06	515	4.22
Value \$500,000 - \$749,999	778	27.86	1,263	16.75	2,921	23.96
Value \$750,000 - \$999,999	362	12.97	1,256	16.66	2,357	19.34
Value \$1,000,000 or more	1,022	36.60	3,796	50.34	4,960	40.69
2017 Est. Median All Owner-Occupied Housing Value	—	745,558.95	—	1,000,000.01	—	965,023.01

Benchmark: USA

Copyright © 2017 by Environics Analytics (EA). Source: Claritas - Pop-Facts Premier 2017, .

# Pop-Facts Demographics Snapshot | Housing & Households

Trade Area: 10528 (Harrison, NY), 10580 Rye, NY, 10804 New Rochelle

Total Population: 12,305, 30,558, 44,541

Total Households: 4,633, 11,073, 15,994

	10528 (Harrison, NY)		10580 Rye, NY		10804 New Rochelle	
	Count	%	Count	%	Count	%
<b>2017 Est. Housing Units by Units in Structure</b>						
1 Unit Attached	172	3.50	505	4.25	580	3.41
1 Unit Detached	2,620	53.24	7,244	61.03	11,645	68.43
2 Units	1,139	23.15	1,462	12.32	1,519	8.93
3 to 4 Units	321	6.52	520	4.38	524	3.08
5 to 19 Units	189	3.84	636	5.36	673	3.96
20 to 49 Units	246	5.00	492	4.14	735	4.32
50 or More Units	223	4.53	994	8.38	1,325	7.79
Mobile Home or Trailer	11	0.22	16	0.14	16	0.09
Boat, RV, Van, etc.	0	0.00	0	0.00	0	0.00
<b>2017 Est. Housing Units by Year Structure Built</b>						
Built 2010 or Later	235	4.78	615	5.18	713	4.19
Built 2000 to 2009	347	7.05	666	5.61	803	4.72
Built 1990 to 1999	163	3.31	495	4.17	540	3.17
Built 1980 to 1989	304	6.18	786	6.62	1,014	5.96
Built 1970 to 1979	403	8.19	863	7.44	1,193	7.01
Built 1960 to 1969	664	13.49	1,462	12.32	1,950	11.46
Built 1950 to 1959	941	19.12	2,232	18.80	3,766	22.13
Built 1940 to 1949	456	9.27	916	7.72	1,327	7.80
Built 1939 or Earlier	1,408	28.61	3,814	32.13	5,711	33.56
<b>2017 Housing Units by Year Structure Built</b>						
2017 Est. Median Year Structure Built	—	1,956.37	—	1,955.51	—	1,954.14
<b>2017 Est. Households by Presence of People Under 18</b>						
2017 Est. Households by Presence of People Under 18	1,723	37.19	4,536	40.97	6,412	40.09
<b>Households with 1 or More People under Age 18</b>						
Married Couple Family	1,409	81.78	3,930	86.64	5,611	87.51
Other Family, Male Householder	53	3.08	124	2.73	161	2.51
Other Family, Female Householder	252	14.63	473	10.43	629	9.81
NonFamily Household, Male Householder	8	0.46	8	0.18	10	0.16
NonFamily Household, Female Householder	1	0.06	1	0.02	1	0.02
<b>Households with No People under Age 18</b>						
Households with No People under Age 18	2,910	62.81	6,537	59.03	9,582	59.91
Married Couple Family	1,331	45.74	3,032	46.38	4,847	50.58
Other Family, Male Householder	86	2.96	146	2.23	213	2.22
Other Family, Female Householder	222	7.63	395	6.04	549	5.73
NonFamily, Male Householder	524	18.01	1,081	16.54	1,402	14.63
NonFamily, Female Householder	747	25.67	1,883	28.80	2,571	26.83

Benchmark: USA

Copyright © 2017 by Environics Analytics (EA). Source: Claritas - Pop-Facts Premier 2017, .

# Pop-Facts Demographics Snapshot | Affluence & Education

Trade Area: 10528 (Harrison, NY), 10580 Rye, NY, 10804 New Rochelle

Total Population: 12,305, 30,558, 44,541

Total Households: 4,633, 11,073, 15,994

	10528 (Harrison, NY)		10580 Rye, NY		10804 New Rochelle	
	Count	%	Count	%	Count	%
<b>2017 Est. Pop Age 25+ by Edu. Attainment</b>						
Less than 9th Grade	417	4.98	636	3.25	757	2.62
Some High School, No Diploma	311	3.71	542	2.77	657	2.27
High School Graduate (or GED)	1,471	17.56	2,478	12.67	3,290	11.38
Some College, No Degree	1,220	14.56	2,414	12.34	3,413	11.81
Associate's Degree	444	5.30	883	4.51	1,229	4.25
Bachelor's Degree	2,501	29.86	6,662	34.06	9,430	32.62
Master's Degree	1,314	15.69	3,897	19.92	6,177	21.37
Professional Degree	505	6.03	1,553	7.94	3,029	10.48
Doctorate Degree	193	2.30	494	2.53	928	3.21
<b>2017 Est. Pop Age 25+ by Edu. Attain., Hisp./Lat.</b>						
High School Diploma	222	24.61	286	17.62	325	15.43
High School Graduate	204	22.62	332	20.46	387	18.37
Some College or Associate's Degree	234	25.94	369	22.74	495	23.49
Bachelor's Degree or Higher	242	26.83	636	39.19	900	42.72
<b>2017 Est. Households by HH Income</b>						
Income < \$15,000	265	5.72	595	5.37	737	4.61
Income \$15,000 - \$24,999	291	6.28	529	4.78	705	4.41
Income \$25,000 - \$34,999	216	4.66	434	3.92	601	3.76
Income \$35,000 - \$49,999	424	9.15	774	6.99	1,061	6.63
Income \$50,000 - \$74,999	479	10.34	921	8.32	1,298	8.12
Income \$75,000 - \$99,999	374	8.07	828	7.48	1,157	7.23
Income \$100,000 - \$124,999	401	8.65	927	8.37	1,319	8.25
Income \$125,000 - \$149,999	376	8.12	765	6.91	1,139	7.12
Income \$150,000 - \$199,999	527	11.38	1,280	11.56	1,886	11.79
Income \$200,000 - \$249,999	312	6.73	804	7.26	1,179	7.37
Income \$250,000 - \$499,999	525	11.33	1,522	13.74	2,316	14.48
Income \$500,000+	443	9.56	1,694	15.30	2,596	16.23
2017 Est. Average Household Income	—	169,335.00	—	206,160.42	—	214,047.00
2017 Est. Median Household Income	—	116,638.50	—	141,873.15	—	149,532.32
<b>2017 Median HH Inc. by Single-Class. Race or Eth.</b>						
White Alone	—	117,124.18	—	145,509.75	—	180,283.31
Black or African American Alone	—	147,497.70	—	114,641.99	—	148,966.17
American Indian and Alaskan Native Alone	—	55,768.21	—	78,490.22	—	77,945.61
Asian Alone	—	191,666.48	—	200,000.06	—	200,000.02
Native Hawaiian and Other Pacific Islander Alone	—	100,000.00	—	67,984.38	—	50,000.00
Some Other Race Alone	—	31,533.95	—	29,545.50	—	35,738.56
Two or More Races	—	90,515.68	—	111,432.16	—	116,161.91
Hispanic or Latino	—	44,767.50	—	52,055.63	—	84,639.12
Not Hispanic or Latino	—	127,753.65	—	149,962.62	—	183,691.19
<b>2017 Est. Families by Poverty Status</b>						
2017 Families at or Above Poverty	3,148	93.94	7,768	95.88	11,587	96.47
2017 Families at or Above Poverty with children	1,697	50.64	4,358	53.79	6,127	51.01
2017 Families Below Poverty	203	6.06	334	4.12	424	3.53
2017 Families Below Poverty with children	130	3.88	212	2.62	250	2.08

Benchmark: USA

Copyright © 2017 by Environics Analytics (EA). Source: Claritas - Pop-Facts Premier 2017, .

# Pop-Facts Demographics Snapshot | Employment & Occupation

Trade Area: 10528 (Harrison, NY), 10580 Rye, NY, 10804 New Rochelle

Total Population: 12,305, 30,558, 44,541

Total Households: 4,633, 11,073, 15,994

	10528 (Harrison, NY)		10580 Rye, NY		10804 New Rochelle	
	Count	%	Count	%	Count	%
<b>2017 Est. Employed Civilian Population 16+ by Occupation Classification</b>						
White Collar	4,836	79.12	11,381	82.73	17,459	84.19
Blue Collar	553	9.05	953	6.93	1,321	6.37
Service and Farming	723	11.83	1,423	10.34	1,958	9.44
<b>2017 Est. Workers Age 16+ by Travel Time to Work</b>						
Less than 15 Minutes	1,465	25.44	2,999	23.84	4,056	21.79
15 - 29 Minutes	1,680	29.18	3,284	26.11	4,933	26.50
30 - 44 Minutes	658	11.43	1,382	10.99	2,482	13.33
45 - 59 Minutes	655	11.38	1,657	13.17	2,407	12.93
60 or more Minutes	1,300	22.58	3,256	25.89	4,736	25.44
2017 Est. Avg Travel Time to Work in Minutes	—	36.00	—	38.71	—	38.80
<b>2017 Est. Workers Age 16+ by Transp. to Work</b>						
2017 Est. Workers Age 16+ by Transp. to Work	6,002	100.00	13,375	100.00	20,198	100.00
Drove Alone	3,557	59.26	7,295	54.54	11,158	55.24
Carpooled	290	4.83	631	4.72	989	4.90
Public Transport	1,608	26.79	4,072	30.45	5,693	28.19
Walked	217	3.62	379	2.83	537	2.66
Bicycle	35	0.58	53	0.40	56	0.28
Other Means	46	0.77	156	1.17	178	0.88
Worked at Home	249	4.15	789	5.90	1,587	7.86
<b>2017 Est. Civ. Employed Pop 16+ by Class of Worker</b>						
2017 Est. Civ. Employed Pop 16+ by Class of Worker	6,112	100.00	13,757	100.00	20,738	100.00
For-Profit Private Workers	3,750	61.35	8,820	64.11	12,467	60.12
Non-Profit Private Workers	666	10.90	1,252	9.10	2,048	9.88
Local Government Workers	578	9.46	975	7.09	1,618	7.80
State Government Workers	82	1.34	305	2.22	407	1.96
Federal Government Workers	120	1.96	249	1.81	382	1.84
Self-Employed Workers	911	14.90	2,141	15.56	3,797	18.31
Unpaid Family Workers	5	0.08	15	0.11	19	0.09
<b>2017 Est. Civ. Employed Pop 16+ by Occupation</b>						
Architecture/Engineering	65	1.06	105	0.76	229	1.10
Arts/Design/Entertainment/Sports/Media	266	4.35	687	4.99	923	4.45
Building/Grounds Cleaning/Maintenance	153	2.50	319	2.32	418	2.02
Business/Financial Operations	455	7.44	1,244	9.04	1,857	8.96
Community/Social Services	73	1.19	122	0.89	252	1.22
Computer/Mathematical	73	1.19	215	1.56	410	1.98
Construction/Extraction	265	4.34	427	3.10	554	2.67
Education/Training/Library	572	9.36	1,171	8.51	1,827	8.81
Farming/Fishing/Forestry	2	0.03	6	0.04	7	0.03
Food Preparation/Serving Related	189	3.09	368	2.67	475	2.29
Healthcare Practitioner/Technician	346	5.66	803	5.84	1,626	7.84
Healthcare Support	76	1.24	134	0.97	166	0.80
Installation/Maintenance/Repair	163	2.67	247	1.79	361	1.74
Legal	212	3.47	491	3.57	990	4.77
Life/Physical/Social Science	40	0.65	174	1.26	311	1.50
Management	1,272	20.81	2,910	21.15	4,167	20.09
Office/Administrative Support	624	10.21	1,224	8.90	1,715	8.27
Production	73	1.19	131	0.95	202	0.97
Protective Services	103	1.69	172	1.25	313	1.51
Sales/Related	838	13.71	2,235	16.25	3,152	15.20
Personal Care/Service	200	3.27	424	3.08	579	2.79
Transportation/Material Moving	52	0.85	148	1.08	204	0.98
<b>2017 Est. Pop Age 16+ by Employment Status</b>						
In Armed Forces	0	0.00	0	0.00	3	0.01
Civilian - Employed	6,101	61.99	13,740	58.37	20,749	59.89
Civilian - Unemployed	376	3.82	813	3.45	1,215	3.51
Not in Labor Force	3,365	34.19	8,988	38.18	12,680	36.60

Benchmark: USA

Copyright © 2017 by Environics Analytics (EA). Source: Claritas - Pop-Facts Premier 2017, .



# Pop-Facts Demographics Snapshot | Map

Trade Area: 10528 (Harrison, NY), 10580 Rye, NY, 10804 New Rochelle

Total Population: 12,305, 30,558, 44,541

Total Households: 4,633, 11,073, 15,994

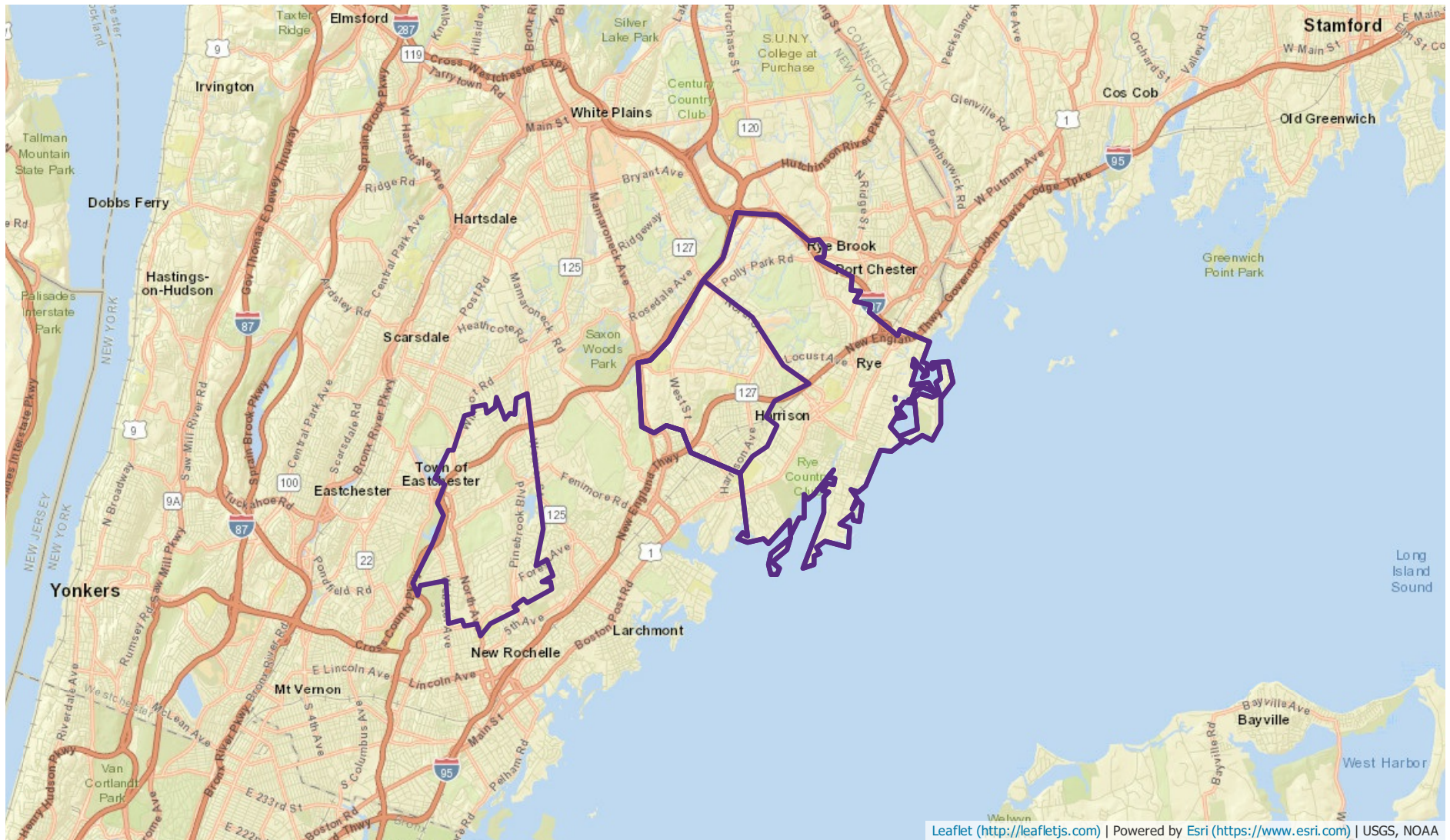

# Pop-Facts Demographics Snapshot | Summary

Trade Area: 10804 New Rochelle

	10804 New Rochelle Total	%
<b>Population</b>		
2000 Census	42,761	100.00
2010 Census	43,318	100.00
2017 Estimate	44,541	100.00
2022 Projection	45,470	100.00
<b>Population Growth</b>		
Percent Change: 2000 to 2010	--	1.30
Percent Change: 2010 to 2017	--	2.82
Percent Change: 2017 to 2022	--	2.09

	10804 New Rochelle Total	%
<b>Households</b>		
2000 Census	15,299	100.00
2010 Census	15,431	100.00
2017 Estimate	15,994	100.00
2022 Projection	16,394	100.00
<b>Household Growth</b>		
Percent Change: 2000 to 2010	--	0.86
Percent Change: 2010 to 2017	--	3.65
Percent Change: 2017 to 2022	--	2.50

	10804 New Rochelle Total	%
<b>Family Households</b>		
2000 Census	11,745	100.00
2010 Census	11,620	100.00
2017 Estimate	12,011	100.00
2022 Projection	12,291	100.00
<b>Family Household Growth</b>		
Percent Change: 2000 to 2010	--	-1.06
Percent Change: 2010 to 2017	--	3.37
Percent Change: 2017 to 2022	--	2.33

Benchmark: USA

Copyright © 2017 by Environics Analytics (EA). Source: Claritas - Pop-Facts Premier 2017, .

# Pop-Facts Demographics Snapshot | Population & Race

Trade Area: 10804 New Rochelle

Total Population: 44,541

Total Households: 15,994

	10804 New Rochelle Count	%
<b>2017 Est. Population by Single-Classification Race</b>		
White Alone	37,722	84.69
Black/African American Alone	1,623	3.64
American Indian/Alaskan Native Alone	73	0.16
Asian Alone	3,172	7.12
Native Hawaiian/Pacific Islander Alone	12	0.03
Some Other Race Alone	913	2.05
Two or More Races	1,026	2.30
<b>2017 Est. Population by Hispanic or Latino Origin</b>		
Not Hispanic or Latino	40,892	91.81
Hispanic or Latino	3,649	8.19
Mexican	626	17.16
Puerto Rican	761	20.86
Cuban	207	5.67
All Other Hispanic or Latino	2,055	56.32
<b>2017 Est. Pop by Race, Asian Alone, by Category</b>		
Chinese, except Taiwanese	534	16.84
Filipino	131	4.13
Japanese	1,520	47.92
Asian Indian	506	15.95
Korean	197	6.21
Vietnamese	17	0.54
Cambodian	19	0.60
Hmong	1	0.03
Laotian	0	0.00
Thai	19	0.60
All Other Asian Races Including 2+ Category	228	7.19
<b>2017 Est. Population by Ancestry</b>		
Arab	499	1.12
Czech	76	0.17
Danish	45	0.10
Dutch	136	0.30
English	1,560	3.50
French (Excluding Basque)	609	1.37
French Canadian	16	0.04
German	2,230	5.01
Greek	311	0.70
Hungarian	275	0.62
Irish	4,008	9.00
Italian	7,826	17.57
Lithuanian	282	0.63
Norwegian	126	0.28
Polish	1,576	3.54
Portuguese	198	0.45
Russian	1,945	4.37
Scottish	258	0.58
Scotch-Irish	62	0.14
Slovak	41	0.09
Sub-Saharan African	217	0.49
Swedish	290	0.65
Swiss	58	0.13
Ukrainian	127	0.28
United States or American	4,821	10.82
Welsh	34	0.08
West Indian (except Hisp. groups)	417	0.94
Other ancestries	12,262	27.53
Ancestries Unclassified	4,236	9.51
<b>2017 Est. Pop Age 5+ by Language Spoken At Home</b>		
Speak Only English at Home	31,880	76.22
Speak Asian/Pacific Isl. Lang. at Home	2,366	5.66
Speak Indo-European Language at Home	4,003	9.57
Speak Spanish at Home	2,839	6.79
Speak Other Language at Home	736	1.76
<b>2017 Est. Hisp. or Latino Pop by Single-Class. Race</b>		
White Alone	2,344	64.24
Black/African American Alone	122	3.34
American Indian/Alaskan Native Alone	55	1.51
Asian Alone	22	0.60
Native Hawaiian/Pacific Islander Alone	0	0.00
Some Other Race Alone	830	22.75
Two or More Races	276	7.56

Benchmark: USA

Copyright © 2017 by Environics Analytics (EA). Source: Claritas - Pop-Facts Premier 2017, .



# Pop-Facts Demographics Snapshot | Population & Race

Trade Area: 10804 New Rochelle

Total Population: 44,541

Total Households: 15,994

	10804 New Rochelle Count	%
<b>2017 Est. Population by Sex</b>		
Male	21,508	48.29
Female	23,033	51.71
<b>2017 Est. Population by Age</b>		
Age 0 - 4	2,717	6.10
Age 5 - 9	2,931	6.58
Age 10 - 14	3,519	7.90
Age 15 - 17	2,189	4.92
Age 18 - 20	1,905	4.28
Age 21 - 24	2,370	5.32
Age 25 - 34	3,581	8.04
Age 35 - 44	4,319	9.70
Age 45 - 54	6,897	15.48
Age 55 - 64	6,411	14.39
Age 65 - 74	3,936	8.84
Age 75 - 84	2,338	5.25
Age 85 and over	1,428	3.21
Age 16 and over	34,647	77.79
Age 18 and over	33,185	74.50
Age 21 and over	31,280	70.23
Age 65 and over	7,702	17.29
Median Age	—	42.49
Average Age	—	40.37
<b>2017 Est. Pop Age 15+ by Marital Status</b>		
Total, Never Married	8,351	23.61
Male, Never Married	4,351	12.30
Female, Never Married	4,000	11.31
Married, Spouse Present	21,740	61.46
Married, Spouse Absent	1,252	3.54
Widowed	2,096	5.92
Male, Widowed	375	1.06
Female, Widowed	1,721	4.87
Divorced	1,935	5.47
Male, Divorced	677	1.91
Female, Divorced	1,258	3.56
<b>2017 Est. Male Population by Age</b>		
Male: Age 0 - 4	1,386	6.44
Male: Age 5 - 9	1,473	6.85
Male: Age 10 - 14	1,844	8.57
Male: Age 15 - 17	1,127	5.24
Male: Age 18 - 20	983	4.57
Male: Age 21 - 24	1,207	5.61
Male: Age 25 - 34	1,742	8.10
Male: Age 35 - 44	2,003	9.31
Male: Age 45 - 54	3,284	15.27
Male: Age 55 - 64	3,098	14.40
Male: Age 65 - 74	1,848	8.59
Male: Age 75 - 84	1,008	4.69
Male: Age 85 and over	505	2.35
Median Age, Male	—	40.42
Average Age, Male	—	39.02
<b>2017 Est. Female Population by Age</b>		
Female: Age 0 - 4	1,331	5.78
Female: Age 5 - 9	1,458	6.33
Female: Age 10 - 14	1,675	7.27
Female: Age 15 - 17	1,062	4.61
Female: Age 18 - 20	922	4.00
Female: Age 21 - 24	1,163	5.05
Female: Age 25 - 34	1,839	7.98
Female: Age 35 - 44	2,316	10.05
Female: Age 45 - 54	3,613	15.69
Female: Age 55 - 64	3,313	14.38
Female: Age 65 - 74	2,088	9.06
Female: Age 75 - 84	1,330	5.77
Female: Age 85 and over	923	4.01
Median Age, Female	—	44.10
Average Age, Female	—	41.62

Benchmark: USA

Copyright © 2017 by Environics Analytics (EA). Source: Claritas - Pop-Facts Premier 2017, .

# Pop-Facts Demographics Snapshot | Housing & Households

Trade Area: 10804 New Rochelle

Total Population: 44,541

Total Households: 15,994

	10804 New Rochelle Count	%
<b>2017 Est. Households by Household Type</b>		
Family Households	12,011	75.10
NonFamily Households	3,983	24.90
<b>2017 Est. Group Quarters Population</b>		
2017 Est. Group Quarters Population	240	0.54
<b>2017 HHs By Ethnicity, Hispanic/Latino</b>		
2017 HHs By Ethnicity, Hispanic/Latino	1,044	6.53
<b>2017 Est. Family HH Type by Presence of Own Child.</b>		
Married Couple Family, own children	5,528	46.02
Married Couple Family, no own children	4,933	41.07
Male Householder, own children	135	1.12
Male Householder, no own children	239	1.99
Female Householder, own children	550	4.58
Female Householder, no own children	626	5.21
<b>2017 Est. Households by Household Size</b>		
1-Person Household	3,559	22.25
2-Person Household	4,652	29.09
3-Person Household	2,668	16.68
4-Person Household	2,985	18.66
5-Person Household	1,535	9.60
6-Person Household	456	2.85
7-or-more-person	139	0.87
2017 Est. Average Household Size	—	2.77
<b>2017 Est. Households by Number of Vehicles</b>		
No Vehicles	970	6.07
1 Vehicle	4,633	28.97
2 Vehicles	7,055	44.11
3 Vehicles	2,502	15.64
4 Vehicles	691	4.32
5 or more Vehicles	143	0.89
2017 Est. Average Number of Vehicles	—	1.90
<b>2017 Est. Occupied Housing Units by Tenure</b>		
Housing Units, Owner-Occupied	12,189	76.21
Housing Units, Renter-Occupied	3,805	23.79
<b>2017 Owner Occ. HUs: Avg. Length of Residence</b>		
2017 Owner Occ. HUs: Avg. Length of Residence	—	18.97
<b>2017 Renter Occ. HUs: Avg. Length of Residence</b>		
2017 Renter Occ. HUs: Avg. Length of Residence	—	7.52
<b>2017 Est. Owner-Occupied Housing Units by Value</b>		
Value Less than \$20,000	195	1.60
Value \$20,000 - \$39,999	21	0.17
Value \$40,000 - \$59,999	13	0.11
Value \$60,000 - \$79,999	55	0.45
Value \$80,000 - \$99,999	40	0.33
Value \$100,000 - \$149,999	81	0.67
Value \$150,000 - \$199,999	193	1.58
Value \$200,000 - \$299,999	385	3.16
Value \$300,000 - \$399,999	453	3.72
Value \$400,000 - \$499,999	515	4.22
Value \$500,000 - \$749,999	2,921	23.96
Value \$750,000 - \$999,999	2,357	19.34
Value \$1,000,000 or more	4,960	40.69
2017 Est. Median All Owner-Occupied Housing Value	—	965,023.01

Benchmark: USA

Copyright © 2017 by Environics Analytics (EA). Source: Claritas - Pop-Facts Premier 2017, .

# Pop-Facts Demographics Snapshot | Housing & Households

Trade Area: 10804 New Rochelle

Total Population: 44,541

Total Households: 15,994

	10804 New Rochelle Count	%
<b>2017 Est. Housing Units by Units in Structure</b>		
1 Unit Attached	580	3.41
1 Unit Detached	11,645	68.43
2 Units	1,519	8.93
3 to 4 Units	524	3.08
5 to 19 Units	673	3.96
20 to 49 Units	735	4.32
50 or More Units	1,325	7.79
Mobile Home or Trailer	16	0.09
Boat, RV, Van, etc.	0	0.00
<b>2017 Est. Housing Units by Year Structure Built</b>		
Built 2010 or Later	713	4.19
Built 2000 to 2009	803	4.72
Built 1990 to 1999	540	3.17
Built 1980 to 1989	1,014	5.96
Built 1970 to 1979	1,193	7.01
Built 1960 to 1969	1,950	11.46
Built 1950 to 1959	3,766	22.13
Built 1940 to 1949	1,327	7.80
Built 1939 or Earlier	5,711	33.56
<b>2017 Housing Units by Year Structure Built</b>		
2017 Est. Median Year Structure Built	—	1,954.14
<b>2017 Est. Households by Presence of People Under 18</b>		
2017 Est. Households by Presence of People Under 18	6,412	40.09
<b>Households with 1 or More People under Age 18</b>		
Married Couple Family	5,611	87.51
Other Family, Male Householder	161	2.51
Other Family, Female Householder	629	9.81
NonFamily Household, Male Householder	10	0.16
NonFamily Household, Female Householder	1	0.02
<b>Households with No People under Age 18</b>		
Households with No People under Age 18	9,582	59.91
Married Couple Family	4,847	50.58
Other Family, Male Householder	213	2.22
Other Family, Female Householder	549	5.73
NonFamily, Male Householder	1,402	14.63
NonFamily, Female Householder	2,571	26.83

Benchmark: USA

Copyright © 2017 by Environics Analytics (EA). Source: Claritas - Pop-Facts Premier 2017, .

# Pop-Facts Demographics Snapshot | Affluence & Education

Trade Area: 10804 New Rochelle

Total Population: 44,541

Total Households: 15,994

	10804 New Rochelle	
	Count	%
<b>2017 Est. Pop Age 25+ by Edu. Attainment</b>		
Less than 9th Grade	757	2.62
Some High School, No Diploma	657	2.27
High School Graduate (or GED)	3,290	11.38
Some College, No Degree	3,413	11.81
Associate's Degree	1,229	4.25
Bachelor's Degree	9,430	32.62
Master's Degree	6,177	21.37
Professional Degree	3,029	10.48
Doctorate Degree	928	3.21
<b>2017 Est. Pop Age 25+ by Edu. Attain., Hisp./Lat.</b>		
High School Diploma	325	15.43
High School Graduate	387	18.37
Some College or Associate's Degree	495	23.49
Bachelor's Degree or Higher	900	42.72
<b>2017 Est. Households by HH Income</b>		
Income < \$15,000	737	4.61
Income \$15,000 - \$24,999	705	4.41
Income \$25,000 - \$34,999	601	3.76
Income \$35,000 - \$49,999	1,061	6.63
Income \$50,000 - \$74,999	1,298	8.12
Income \$75,000 - \$99,999	1,157	7.23
Income \$100,000 - \$124,999	1,319	8.25
Income \$125,000 - \$149,999	1,139	7.12
Income \$150,000 - \$199,999	1,886	11.79
Income \$200,000 - \$249,999	1,179	7.37
Income \$250,000 - \$499,999	2,316	14.48
Income \$500,000+	2,596	16.23
2017 Est. Average Household Income	-	214,047.00
2017 Est. Median Household Income	-	149,532.32
<b>2017 Median HH Inc. by Single-Class. Race or Eth.</b>		
White Alone	-	180,283.31
Black or African American Alone	-	148,966.17
American Indian and Alaskan Native Alone	-	77,945.61
Asian Alone	-	200,000.02
Native Hawaiian and Other Pacific Islander Alone	-	50,000.00
Some Other Race Alone	-	35,738.56
Two or More Races	-	116,161.91
Hispanic or Latino	-	84,639.12
Not Hispanic or Latino	-	183,691.19
<b>2017 Est. Families by Poverty Status</b>		
2017 Families at or Above Poverty	11,587	96.47
2017 Families at or Above Poverty with children	6,127	51.01
2017 Families Below Poverty	424	3.53
2017 Families Below Poverty with children	250	2.08

Benchmark: USA

Copyright © 2017 by Environics Analytics (EA). Source: Claritas - Pop-Facts Premier 2017, .

# Pop-Facts Demographics Snapshot | Employment & Occupation

Trade Area: 10804 New Rochelle

Total Population: 44,541

Total Households: 15,994

	10804 New Rochelle Count	%
<b>2017 Est. Employed Civilian Population 16+ by Occupation Classification</b>		
White Collar	17,459	84.19
Blue Collar	1,321	6.37
Service and Farming	1,958	9.44
<b>2017 Est. Workers Age 16+ by Travel Time to Work</b>		
Less than 15 Minutes	4,056	21.79
15 - 29 Minutes	4,933	26.50
30 - 44 Minutes	2,482	13.33
45 - 59 Minutes	2,407	12.93
60 or more Minutes	4,736	25.44
2017 Est. Avg Travel Time to Work in Minutes	—	38.80
<b>2017 Est. Workers Age 16+ by Transp. to Work</b>		
2017 Est. Workers Age 16+ by Transp. to Work	20,198	100.00
Drove Alone	11,158	55.24
Carpooled	989	4.90
Public Transport	5,693	28.19
Walked	537	2.66
Bicycle	56	0.28
Other Means	178	0.88
Worked at Home	1,587	7.86
<b>2017 Est. Civ. Employed Pop 16+ by Class of Worker</b>		
2017 Est. Civ. Employed Pop 16+ by Class of Worker	20,738	100.00
For-Profit Private Workers	12,467	60.12
Non-Profit Private Workers	2,048	9.88
Local Government Workers	1,618	7.80
State Government Workers	407	1.96
Federal Government Workers	382	1.84
Self-Employed Workers	3,797	18.31
Unpaid Family Workers	19	0.09
<b>2017 Est. Civ. Employed Pop 16+ by Occupation</b>		
Architecture/Engineering	229	1.10
Arts/Design/Entertainment/Sports/Media	923	4.45
Building/Grounds Cleaning/Maintenance	418	2.02
Business/Financial Operations	1,857	8.96
Community/Social Services	252	1.22
Computer/Mathematical	410	1.98
Construction/Extraction	554	2.67
Education/Training/Library	1,827	8.81
Farming/Fishing/Forestry	7	0.03
Food Preparation/Serving Related	475	2.29
Healthcare Practitioner/Technician	1,626	7.84
Healthcare Support	166	0.80
Installation/Maintenance/Repair	361	1.74
Legal	990	4.77
Life/Physical/Social Science	311	1.50
Management	4,167	20.09
Office/Administrative Support	1,715	8.27
Production	202	0.97
Protective Services	313	1.51
Sales/Related	3,152	15.20
Personal Care/Service	579	2.79
Transportation/Material Moving	204	0.98
<b>2017 Est. Pop Age 16+ by Employment Status</b>		
In Armed Forces	3	0.01
Civilian - Employed	20,749	59.89
Civilian - Unemployed	1,215	3.51
Not in Labor Force	12,680	36.60

Benchmark: USA

Copyright © 2017 by Environics Analytics (EA). Source: Claritas - Pop-Facts Premier 2017, .

# Pop-Facts Demographics Snapshot | Map

Trade Area: 10804 New Rochelle

Total Population: 44,541

Total Households: 15,994

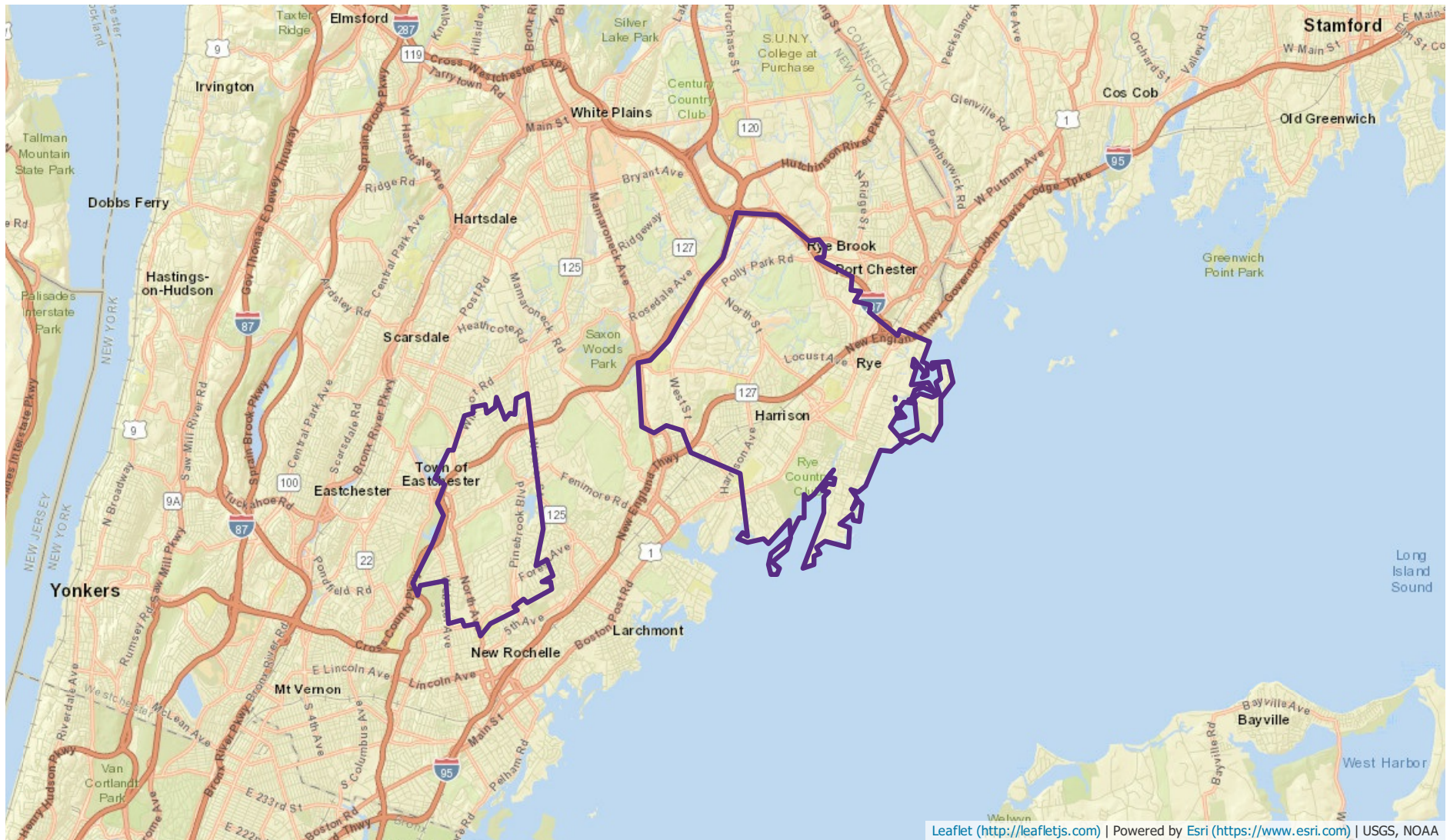



# Pop-Facts Demographics Snapshot | Summary

Trade Area: 10580 Rye, NY

	10580 Rye, NY Total	%
<b>Population</b>		
2000 Census	28,831	100.00
2010 Census	29,483	100.00
2017 Estimate	30,558	100.00
2022 Projection	31,357	100.00
<b>Population Growth</b>		
Percent Change: 2000 to 2010	--	2.26
Percent Change: 2010 to 2017	--	3.65
Percent Change: 2017 to 2022	--	2.62
	10580 Rye, NY Total	%
<b>Households</b>		
2000 Census	10,529	100.00
2010 Census	10,588	100.00
2017 Estimate	11,073	100.00
2022 Projection	11,414	100.00
<b>Household Growth</b>		
Percent Change: 2000 to 2010	--	0.56
Percent Change: 2010 to 2017	--	4.58
Percent Change: 2017 to 2022	--	3.08
	10580 Rye, NY Total	%
<b>Family Households</b>		
2000 Census	7,816	100.00
2010 Census	7,770	100.00
2017 Estimate	8,102	100.00
2022 Projection	8,337	100.00
<b>Family Household Growth</b>		
Percent Change: 2000 to 2010	--	-0.59
Percent Change: 2010 to 2017	--	4.27
Percent Change: 2017 to 2022	--	2.90

Benchmark: USA

Copyright © 2017 by Environics Analytics (EA). Source: Claritas - Pop-Facts Premier 2017, .

# Pop-Facts Demographics Snapshot | Population & Race

Trade Area: 10580 Rye, NY

Total Population: 30,558

Total Households: 11,073

	10580 Rye, NY Count	%
<b>2017 Est. Population by Single-Classification Race</b>		
White Alone	26,064	85.29
Black/African American Alone	477	1.56
American Indian/Alaskan Native Alone	67	0.22
Asian Alone	2,477	8.11
Native Hawaiian/Pacific Islander Alone	3	0.01
Some Other Race Alone	760	2.49
Two or More Races	710	2.32
<b>2017 Est. Population by Hispanic or Latino Origin</b>		
Not Hispanic or Latino	27,760	90.84
Hispanic or Latino	2,798	9.16
Mexican	520	18.59
Puerto Rican	539	19.26
Cuban	144	5.15
All Other Hispanic or Latino	1,595	57.01
<b>2017 Est. Pop by Race, Asian Alone, by Category</b>		
Chinese, except Taiwanese	323	13.04
Filipino	92	3.71
Japanese	1,472	59.43
Asian Indian	291	11.75
Korean	111	4.48
Vietnamese	0	0.00
Cambodian	19	0.77
Hmong	1	0.04
Laotian	0	0.00
Thai	10	0.40
All Other Asian Races Including 2+ Category	158	6.38
<b>2017 Est. Population by Ancestry</b>		
Arab	446	1.46
Czech	1	0.00
Danish	45	0.15
Dutch	135	0.44
English	1,362	4.46
French (Excluding Basque)	248	0.81
French Canadian	9	0.03
German	1,816	5.94
Greek	179	0.59
Hungarian	103	0.34
Irish	3,111	10.18
Italian	5,491	17.97
Lithuanian	216	0.71
Norwegian	104	0.34
Polish	568	1.86
Portuguese	84	0.28
Russian	972	3.18
Scottish	208	0.68
Scotch-Irish	55	0.18
Slovak	39	0.13
Sub-Saharan African	160	0.52
Swedish	170	0.56
Swiss	33	0.11
Ukrainian	84	0.28
United States or American	3,629	11.88
Welsh	15	0.05
West Indian (except Hisp. groups)	76	0.25
Other ancestries	8,450	27.65
Ancestries Unclassified	2,749	9.00
<b>2017 Est. Pop Age 5+ by Language Spoken At Home</b>		
Speak Only English at Home	21,231	74.08
Speak Asian/Pacific Isl. Lang. at Home	2,063	7.20
Speak Indo-European Language at Home	2,686	9.37
Speak Spanish at Home	2,100	7.33
Speak Other Language at Home	580	2.02
<b>2017 Est. Hisp. or Latino Pop by Single-Class. Race</b>		
White Alone	1,776	63.47
Black/African American Alone	65	2.32
American Indian/Alaskan Native Alone	54	1.93
Asian Alone	12	0.43
Native Hawaiian/Pacific Islander Alone	0	0.00
Some Other Race Alone	702	25.09
Two or More Races	189	6.75

Benchmark: USA

Copyright © 2017 by Environics Analytics (EA). Source: Claritas - Pop-Facts Premier 2017, .



# Pop-Facts Demographics Snapshot | Population & Race

Trade Area: 10580 Rye, NY

Total Population: 30,558

Total Households: 11,073

	10580 Rye, NY Count	%
<b>2017 Est. Population by Sex</b>		
Male	14,737	48.23
Female	15,821	51.77
<b>2017 Est. Population by Age</b>		
Age 0 - 4	1,898	6.21
Age 5 - 9	2,098	6.87
Age 10 - 14	2,514	8.23
Age 15 - 17	1,527	5.00
Age 18 - 20	1,325	4.34
Age 21 - 24	1,637	5.36
Age 25 - 34	2,445	8.00
Age 35 - 44	3,125	10.23
Age 45 - 54	4,931	16.14
Age 55 - 64	4,213	13.79
Age 65 - 74	2,408	7.88
Age 75 - 84	1,447	4.74
Age 85 and over	990	3.24
Age 16 and over	23,541	77.04
Age 18 and over	22,521	73.70
Age 21 and over	21,196	69.36
Age 65 and over	4,845	15.86
Median Age	—	41.35
Average Age	—	39.58
<b>2017 Est. Pop Age 15+ by Marital Status</b>		
Total, Never Married	5,716	23.77
Male, Never Married	3,072	12.77
Female, Never Married	2,644	10.99
Married, Spouse Present	14,493	60.27
Married, Spouse Absent	956	3.98
Widowed	1,364	5.67
Male, Widowed	216	0.90
Female, Widowed	1,148	4.77
Divorced	1,519	6.32
Male, Divorced	526	2.19
Female, Divorced	993	4.13
<b>2017 Est. Male Population by Age</b>		
Male: Age 0 - 4	970	6.58
Male: Age 5 - 9	1,051	7.13
Male: Age 10 - 14	1,315	8.92
Male: Age 15 - 17	779	5.29
Male: Age 18 - 20	678	4.60
Male: Age 21 - 24	824	5.59
Male: Age 25 - 34	1,191	8.08
Male: Age 35 - 44	1,462	9.92
Male: Age 45 - 54	2,364	16.04
Male: Age 55 - 64	2,053	13.93
Male: Age 65 - 74	1,125	7.63
Male: Age 75 - 84	597	4.05
Male: Age 85 and over	328	2.23
Median Age, Male	—	39.27
Average Age, Male	—	38.16
<b>2017 Est. Female Population by Age</b>		
Female: Age 0 - 4	928	5.87
Female: Age 5 - 9	1,047	6.62
Female: Age 10 - 14	1,199	7.58
Female: Age 15 - 17	748	4.73
Female: Age 18 - 20	647	4.09
Female: Age 21 - 24	813	5.14
Female: Age 25 - 34	1,254	7.93
Female: Age 35 - 44	1,663	10.51
Female: Age 45 - 54	2,567	16.23
Female: Age 55 - 64	2,160	13.65
Female: Age 65 - 74	1,283	8.11
Female: Age 75 - 84	850	5.37
Female: Age 85 and over	662	4.18
Median Age, Female	—	43.01
Average Age, Female	—	40.90

Benchmark: USA

Copyright © 2017 by Environics Analytics (EA). Source: Claritas - Pop-Facts Premier 2017, .

# Pop-Facts Demographics Snapshot | Housing & Households

Trade Area: 10580 Rye, NY

Total Population: 30,558

Total Households: 11,073

	10580 Rye, NY	
	Count	%
<b>2017 Est. Households by Household Type</b>		
Family Households	8,102	73.17
NonFamily Households	2,971	26.83
<b>2017 Est. Group Quarters Population</b>		
2017 Est. Group Quarters Population	167	0.55
<b>2017 HHs By Ethnicity, Hispanic/Latino</b>		
2017 HHs By Ethnicity, Hispanic/Latino	817	7.38
<b>2017 Est. Family HH Type by Presence of Own Child.</b>		
Married Couple Family, own children	3,879	47.88
Married Couple Family, no own children	3,086	38.09
Male Householder, own children	107	1.32
Male Householder, no own children	163	2.01
Female Householder, own children	420	5.18
Female Householder, no own children	447	5.52
<b>2017 Est. Households by Household Size</b>		
1-Person Household	2,641	23.85
2-Person Household	3,074	27.76
3-Person Household	1,819	16.43
4-Person Household	2,088	18.86
5-Person Household	1,047	9.46
6-Person Household	322	2.91
7-or-more-person	82	0.74
2017 Est. Average Household Size	—	2.74
<b>2017 Est. Households by Number of Vehicles</b>		
No Vehicles	741	6.69
1 Vehicle	3,509	31.69
2 Vehicles	4,679	42.26
3 Vehicles	1,559	14.08
4 Vehicles	492	4.44
5 or more Vehicles	93	0.84
2017 Est. Average Number of Vehicles	—	1.86
<b>2017 Est. Occupied Housing Units by Tenure</b>		
Housing Units, Owner-Occupied	7,540	68.09
Housing Units, Renter-Occupied	3,533	31.91
<b>2017 Owner Occ. HUs: Avg. Length of Residence</b>		
2017 Owner Occ. HUs: Avg. Length of Residence	—	18.65
<b>2017 Renter Occ. HUs: Avg. Length of Residence</b>		
2017 Renter Occ. HUs: Avg. Length of Residence	—	7.35
<b>2017 Est. Owner-Occupied Housing Units by Value</b>		
Value Less than \$20,000	117	1.55
Value \$20,000 - \$39,999	19	0.25
Value \$40,000 - \$59,999	11	0.15
Value \$60,000 - \$79,999	47	0.62
Value \$80,000 - \$99,999	38	0.50
Value \$100,000 - \$149,999	49	0.65
Value \$150,000 - \$199,999	115	1.52
Value \$200,000 - \$299,999	240	3.18
Value \$300,000 - \$399,999	283	3.75
Value \$400,000 - \$499,999	306	4.06
Value \$500,000 - \$749,999	1,263	16.75
Value \$750,000 - \$999,999	1,256	16.66
Value \$1,000,000 or more	3,796	50.34
2017 Est. Median All Owner-Occupied Housing Value	—	1,000,000.01

Benchmark: USA

Copyright © 2017 by Environics Analytics (EA). Source: Claritas - Pop-Facts Premier 2017, .

# Pop-Facts Demographics Snapshot | Housing & Households

Trade Area: 10580 Rye, NY

Total Population: 30,558

Total Households: 11,073

	10580 Rye, NY	
	Count	%
<b>2017 Est. Housing Units by Units in Structure</b>		
1 Unit Attached	505	4.25
1 Unit Detached	7,244	61.03
2 Units	1,462	12.32
3 to 4 Units	520	4.38
5 to 19 Units	636	5.36
20 to 49 Units	492	4.14
50 or More Units	994	8.38
Mobile Home or Trailer	16	0.14
Boat, RV, Van, etc.	0	0.00
<b>2017 Est. Housing Units by Year Structure Built</b>		
Built 2010 or Later	615	5.18
Built 2000 to 2009	666	5.61
Built 1990 to 1999	495	4.17
Built 1980 to 1989	786	6.62
Built 1970 to 1979	883	7.44
Built 1960 to 1969	1,462	12.32
Built 1950 to 1959	2,232	18.80
Built 1940 to 1949	916	7.72
Built 1939 or Earlier	3,814	32.13
<b>2017 Housing Units by Year Structure Built</b>		
2017 Est. Median Year Structure Built	—	1,955.51
<b>2017 Est. Households by Presence of People Under 18</b>		
2017 Est. Households by Presence of People Under 18	4,536	40.97
<b>Households with 1 or More People under Age 18</b>		
Married Couple Family	3,930	86.64
Other Family, Male Householder	124	2.73
Other Family, Female Householder	473	10.43
NonFamily Household, Male Householder	8	0.18
NonFamily Household, Female Householder	1	0.02
<b>Households with No People under Age 18</b>		
Households with No People under Age 18	6,537	59.03
Married Couple Family	3,032	46.38
Other Family, Male Householder	146	2.23
Other Family, Female Householder	395	6.04
NonFamily, Male Householder	1,081	16.54
NonFamily, Female Householder	1,883	28.80

Benchmark: USA

Copyright © 2017 by Environics Analytics (EA). Source: Claritas - Pop-Facts Premier 2017, .

# Pop-Facts Demographics Snapshot | Affluence & Education

Trade Area: 10580 Rye, NY

Total Population: 30,558

Total Households: 11,073

	10580 Rye, NY	
	Count	%
<b>2017 Est. Pop Age 25+ by Edu. Attainment</b>		
Less than 9th Grade	636	3.25
Some High School, No Diploma	542	2.77
High School Graduate (or GED)	2,478	12.67
Some College, No Degree	2,414	12.34
Associate's Degree	883	4.51
Bachelor's Degree	6,662	34.06
Master's Degree	3,897	19.92
Professional Degree	1,553	7.94
Doctorate Degree	494	2.53
<b>2017 Est. Pop Age 25+ by Edu. Attain., Hisp./Lat.</b>		
High School Diploma	286	17.62
High School Graduate	332	20.46
Some College or Associate's Degree	369	22.74
Bachelor's Degree or Higher	636	39.19
<b>2017 Est. Households by HH Income</b>		
Income < \$15,000	595	5.37
Income \$15,000 - \$24,999	529	4.78
Income \$25,000 - \$34,999	434	3.92
Income \$35,000 - \$49,999	774	6.99
Income \$50,000 - \$74,999	921	8.32
Income \$75,000 - \$99,999	828	7.48
Income \$100,000 - \$124,999	927	8.37
Income \$125,000 - \$149,999	765	6.91
Income \$150,000 - \$199,999	1,280	11.56
Income \$200,000 - \$249,999	804	7.26
Income \$250,000 - \$499,999	1,522	13.74
Income \$500,000+	1,694	15.30
2017 Est. Average Household Income	--	206,160.42
2017 Est. Median Household Income	--	141,873.15
<b>2017 Median HH Inc. by Single-Class. Race or Eth.</b>		
White Alone	--	145,509.75
Black or African American Alone	--	114,641.99
American Indian and Alaskan Native Alone	--	78,490.22
Asian Alone	--	200,000.06
Native Hawaiian and Other Pacific Islander Alone	--	67,984.38
Some Other Race Alone	--	29,545.50
Two or More Races	--	111,432.16
Hispanic or Latino	--	52,055.63
Not Hispanic or Latino	--	149,962.62
<b>2017 Est. Families by Poverty Status</b>		
2017 Families at or Above Poverty	7,768	95.88
2017 Families at or Above Poverty with children	4,358	53.79
2017 Families Below Poverty	334	4.12
2017 Families Below Poverty with children	212	2.62

Benchmark: USA

Copyright © 2017 by Environics Analytics (EA). Source: Claritas - Pop-Facts Premier 2017, .

# Pop-Facts Demographics Snapshot | Employment & Occupation

Trade Area: 10580 Rye, NY

Total Population: 30,558

Total Households: 11,073

	10580 Rye, NY Count	%
<b>2017 Est. Employed Civilian Population 16+ by Occupation Classification</b>		
White Collar	11,381	82.73
Blue Collar	953	6.93
Service and Farming	1,423	10.34
<b>2017 Est. Workers Age 16+ by Travel Time to Work</b>		
Less than 15 Minutes	2,999	23.84
15 - 29 Minutes	3,284	26.11
30 - 44 Minutes	1,382	10.99
45 - 59 Minutes	1,657	13.17
60 or more Minutes	3,256	25.89
2017 Est. Avg Travel Time to Work in Minutes	—	38.71
<b>2017 Est. Workers Age 16+ by Transp. to Work</b>		
2017 Est. Workers Age 16+ by Transp. to Work	13,375	100.00
Drove Alone	7,295	54.54
Carpooled	631	4.72
Public Transport	4,072	30.45
Walked	379	2.83
Bicycle	53	0.40
Other Means	156	1.17
Worked at Home	789	5.90
<b>2017 Est. Civ. Employed Pop 16+ by Class of Worker</b>		
2017 Est. Civ. Employed Pop 16+ by Class of Worker	13,757	100.00
For-Profit Private Workers	8,820	64.11
Non-Profit Private Workers	1,252	9.10
Local Government Workers	975	7.09
State Government Workers	305	2.22
Federal Government Workers	249	1.81
Self-Employed Workers	2,141	15.56
Unpaid Family Workers	15	0.11
<b>2017 Est. Civ. Employed Pop 16+ by Occupation</b>		
Architecture/Engineering	105	0.76
Arts/Design/Entertainment/Sports/Media	687	4.99
Building/Grounds Cleaning/Maintenance	319	2.32
Business/Financial Operations	1,244	9.04
Community/Social Services	122	0.89
Computer/Mathematical	215	1.56
Construction/Extraction	427	3.10
Education/Training/Library	1,171	8.51
Farming/Fishing/Forestry	6	0.04
Food Preparation/Serving Related	368	2.67
Healthcare Practitioner/Technician	803	5.84
Healthcare Support	134	0.97
Installation/Maintenance/Repair	247	1.79
Legal	491	3.57
Life/Physical/Social Science	174	1.26
Management	2,910	21.15
Office/Administrative Support	1,224	8.90
Production	131	0.95
Protective Services	172	1.25
Sales/Related	2,235	16.25
Personal Care/Service	424	3.08
Transportation/Material Moving	148	1.08
<b>2017 Est. Pop Age 16+ by Employment Status</b>		
In Armed Forces	0	0.00
Civilian - Employed	13,740	58.37
Civilian - Unemployed	813	3.45
Not in Labor Force	8,988	38.18

Benchmark: USA

Copyright © 2017 by Environics Analytics (EA). Source: Claritas - Pop-Facts Premier 2017, .

# Pop-Facts Demographics Snapshot | Map

Trade Area: 10580 Rye, NY

Total Population: 30,558

Total Households: 11,073

